

TECHNICAL | THIN Primaries Rhombus Surface Mount

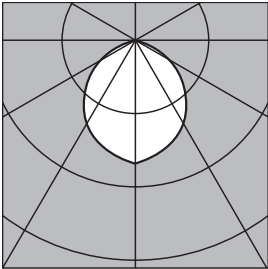

FROSTED LENS
90° BEAM ANGLE

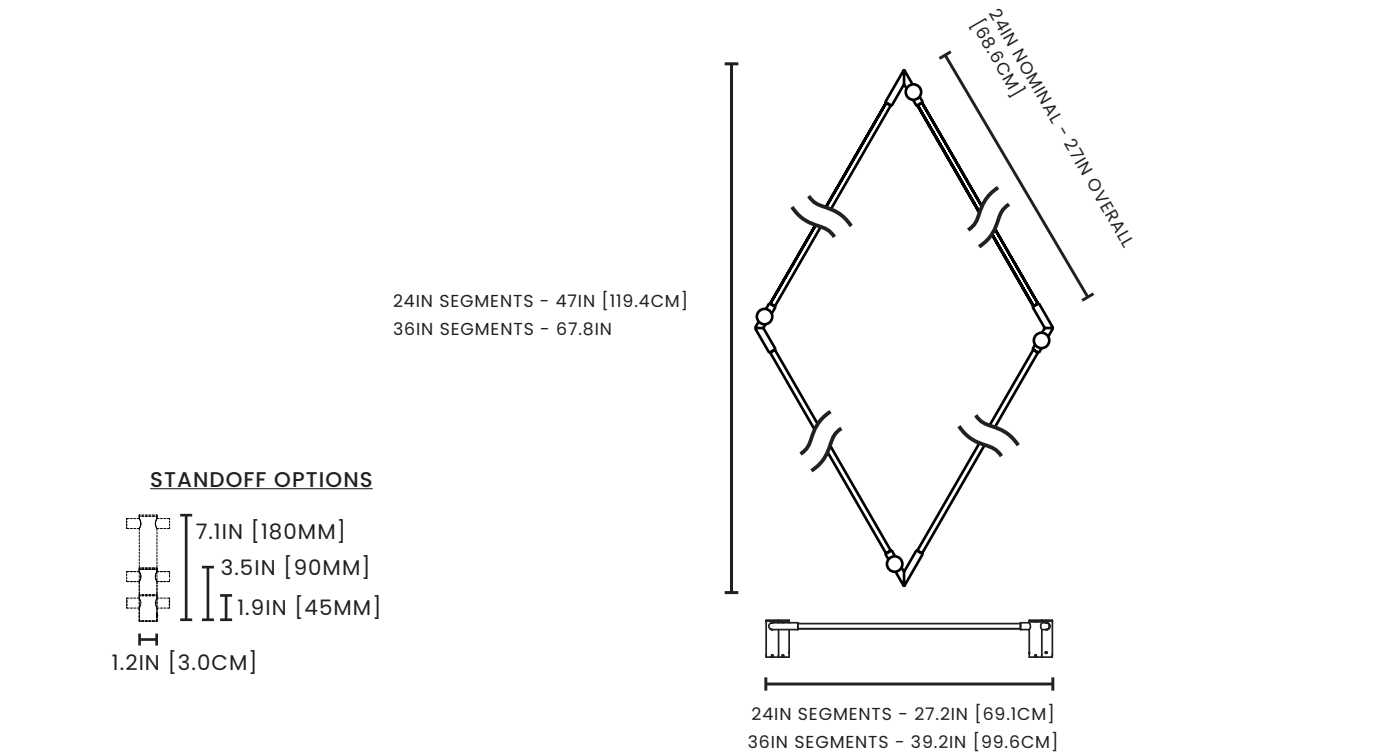
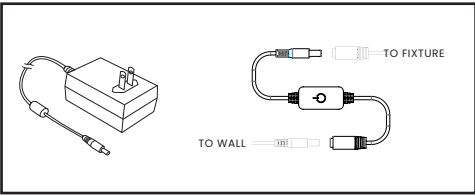

OPTIONAL PLUG-IN POWER SUPPLY WITH
IN-LINE TOUCH DIMMER & 3-METER CORD

ILLUMINATION CRI 95+, R9 90+ standard 2700K, 3000K, 3500K, 4000K options 24" segment 2400LM delivered/27.2W 36" segment 3680LM delivered/38.4W 90LM/W 50,000 hrs LED life L80	FINISHES Satin Brass, Black Oxide, Satin Nickel MATERIALS Solid brass, PMMA DIMMING 2-Wire/TRIAC/Forward Phase 0-10V 3-Wire See Power Supply section for details Contact Juniper for alternate requirements	MOUNTING Wall brackets mount directly to surface 2 X 18AWG in-wall rated cable recommended for remote installation (provided by electrician)
POWER 24VDC output Class 2 constant voltage power supply 120VAC input voltage Remote power supply required Contact Juniper for alternate inputs		

BUILD A SPECIFICATION | THIN Primaries Rhombus Surface Mount

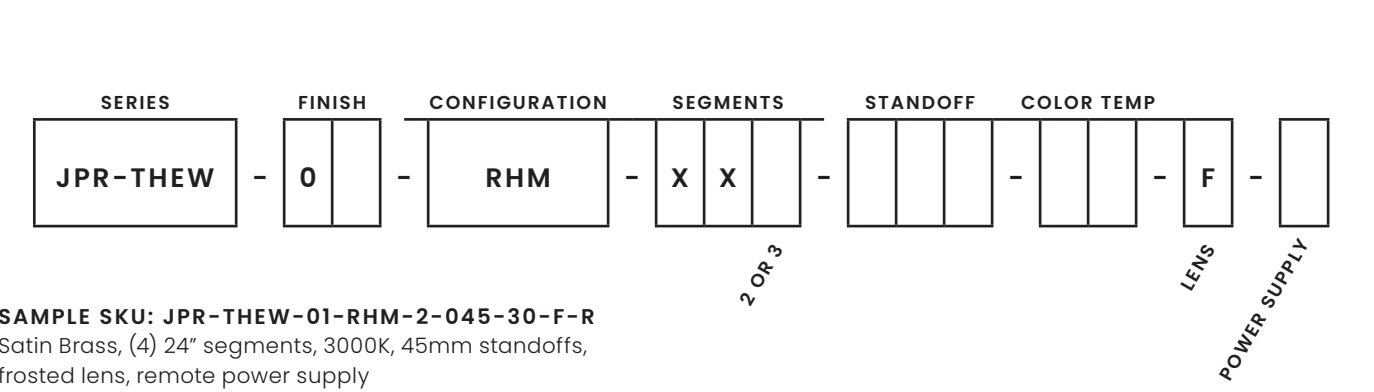

CODE DEFINITIONS

FINISHES



SEGMENTS

2 24 inch - 2400LM delivered / 27.2W
3 36 inch - 3680LM delivered / 38.4W
Contact Juniper for custom segment lengths

STANDOFF LENGTH

045 45mm Standoffs
090 90mm Standoffs
180 180mm Standoffs

COLOR TEMPERATURE

27 2700K
30 3000K
35 3500K
40 4000K

LENS

F Frosted - 90° beam angle

POWER SUPPLY OPTIONS

R. REMOTE

STANDARD 120-277V INPUT - 2-WIRE/TRIAC/FORWARD PHASE/ELV

STANDARD 120-277V INPUT - 0-10V

LUTRON 120V INPUT - TRIAC DIMMING (40W) (UPCHARGE)

LUTRON 120-277V INPUT - 3-WIRE (UPCHARGE)

P. PLUG-IN

24VDC, 1.67A POWER SUPPLY

Our team will determine correct wattages for power supplies based on chosen configuration. Contact Juniper for custom requirements or further power supply specifications.

Project	Type
Notes	