

JUNIPER®

JUNIPER-DESIGN.COM

157 WATER STREET SOUTHTON, CT 06489

JUNIPER®



METROPOLIS SYSTEM

TABLE OF CONTENTS

METROPOLIS SYSTEM AT A GLANCE

Features and Benefits	5
-----------------------	---

SPECIFICATION GUIDE

Metropolis System	7
SKU Builder	8
Suspension to Suspension	9
Wall to Wall	13
Wall to Suspension	17
Field Cuttable Tube Section	21
Light Module	22

SYSTEM SPECIFICATIONS

System And Driver Matrix	23
Power Supply	24
Wiring Diagrams	25
Wiring Diagrams	26
Wiring Diagrams	27
Wiring Diagrams	28
PHOTOMETRICS DATA	29
TM-30 REPORTS COLOR QUALITY	29
Hexagonal Mesh Details	30
Finishes	31



Designed by David Meckley in collaboration with Juniper, the Metropolis System spans the full length of any space with high-output cylindrical modules engineered to offer a powerful lighting solution for workspaces and hospitality settings. The top and bottom of the LED modules can be independently dimmed for direct and indirect illumination, and can be diffused by an optional black mesh, exclusive to the Metropolis Collection.

Updated: 02/06/2024

Patent: www.juniper-design.com/patents/

JUNIPER-DESIGN.COM



+1-347-799-2915

Patent: www.juniper-design.com/patents/

SALES@JUNIPER-DESIGN.COM

Updated: 02/06/2024

METROPOLIS SYSTEM AT A GLANCE

FEATURES AND BENEFITS



UNIQUE STRUCTURE

The Bauhaus-inspired design complements a wide range of architectural spaces

ARCHITECTURAL DIMMING

TRIAC, ELV, or 0-10 V to 1% standard

Independent Direct/Indirect control optional

LIGHT MODULES

Machined aluminum with decorative mesh option

Powerful, high quality light

26" light modules deliver 4000 LM

36" light modules deliver 6100 LM

ADVANCED POWER SUPPLIES

Remotely located 24 VDC power supplies keep fixture installation simple, making maintenance easy

SUPERIOR LIGHT QUALITY

Custom in-house manufactured LED modules with 95+ CRI, 90+ R9 values are standard for enhanced color and vibrancy

RANGE OF COLOR TEMPERATURES

2700 K, 3000 K, 3500 K, 4000 K

FIELD ADJUSTABLE SECTIONS

Suspension tube sections can be cut on site for easy accommodation of changing project conditions

ARCHITECTURAL FINISHES

Satin Brass, Satin Aluminum, Polished Aluminum, Satin Black

Solid brass hardware combines with high-performance aluminum

INSTALLATION

Field-cuttable tube sections, color coded conductors, and leveling screws make things simple

SPECIFICATION GUIDE

METROPOLIS SYSTEM

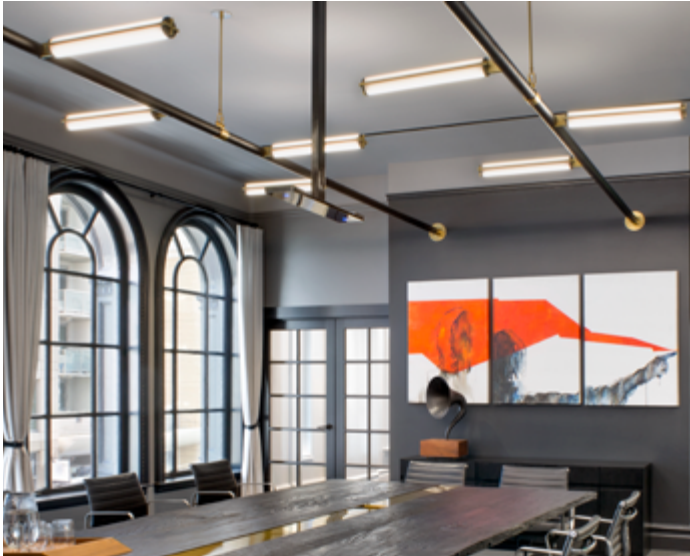

FEATURES AND BENEFITS

Flexible Design

Modular 6 ft section includes two light modules. Light modules come in two sizes: 26" (4000 LM) and 36" (6100 LM).

Advanced Power Supplies

Remotely located 24 VDC power supplies

Superior Light Quality

Custom LED modules with CRI of 95+ and 90+ R9 values

Range of color temperatures

2700 K, 3000 K, 3500 K, 4000 K

SYSTEM COMPONENTS

See p. 10

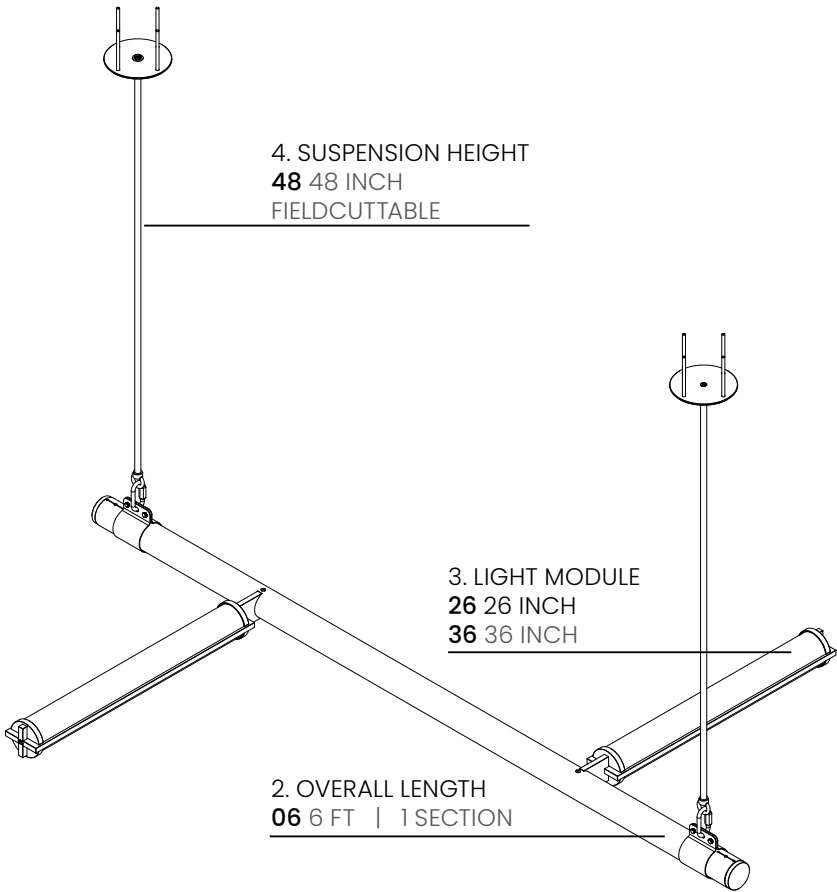

1.SUB-FAMILY

STS1 SUSPENSION TO SUSPENSION

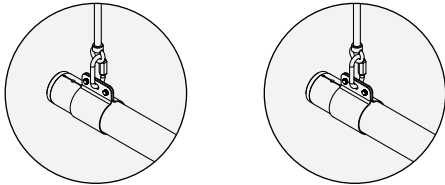

WTW1 WALL TO WALL

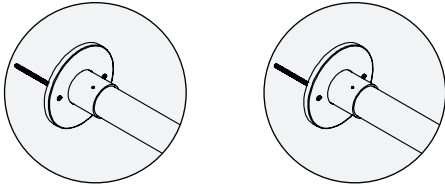

WTS1 WALL TO SUSPENSION

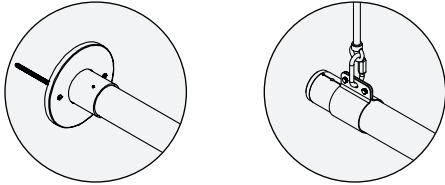

Updated: 02/06/2024

Patent www.juniper-design.com/patents/

SPECIFICATION GUIDE

SKU BUILDER

SPECIFICATION BUILDER

JPR-MTRO-



MODEL	1. SUB-FAMILY	2. OVERALL LENGTH	3. LIGHT MODULE
JPR-MTRO	STS1 SUSPENSION TO SUSPENSION	06 6 FT 1 SECTION	26 26 INCH
	WTW1 WALL TO WALL	12 12 FT 2 SECTIONS	36 36 INCH
	WTS1 WALL TO SUSPENSION	18 18 FT 3 SECTIONS	
		24 24 FT 4 SECTIONS	

4. SUSPENSION HEIGHT	5. POWER SUPPLY	6. CCT
48 48 INCH FIELD CUTTABLE	R REMOTE	27 2700 K
CU CUSTOM		30 3000 K
		35 3500 K
		40 4000 K

7. MESH	8. FINISH
M MESH	14 SATIN BRASS SATIN BLACK TRIMS
N NO MESH	16 SATIN BLACK SATIN BLACK TRIMS
	18 SATIN ALUMINUM SATIN BLACK TRIMS
	19 POLISHED ALUMINUM POLISHED ALUMINUM TRIMS
	42 SATIN ALUMINUM SATIN ALUMINUM TRIMS

* Contact Juniper for customization requests

For detailed photometrics, see [Photometrics Guide](#).

IES files available.



Patent www.juniper-design.com/patents/

Updated: 02/06/2024

STANDARD LAYOUTS
SUSPENSION TO SUSPENSION **STS1**

06 6 FT | 1 SECTION

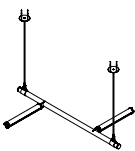

26 26 INCH LIGHT MODULE 36 36 INCH LIGHT MODULE

28 LBS | 1 POWER FEED 32 LBS | 1 POWER FEED

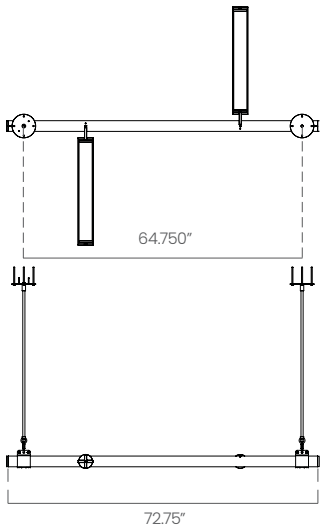

12 12 FT | 2 SECTIONS

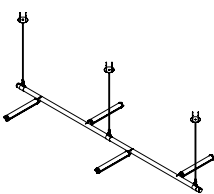

26 26 INCH LIGHT MODULE 36 36 INCH LIGHT MODULE

50 LBS | 1 POWER FEED 57.5 LBS | 1 POWER FEED

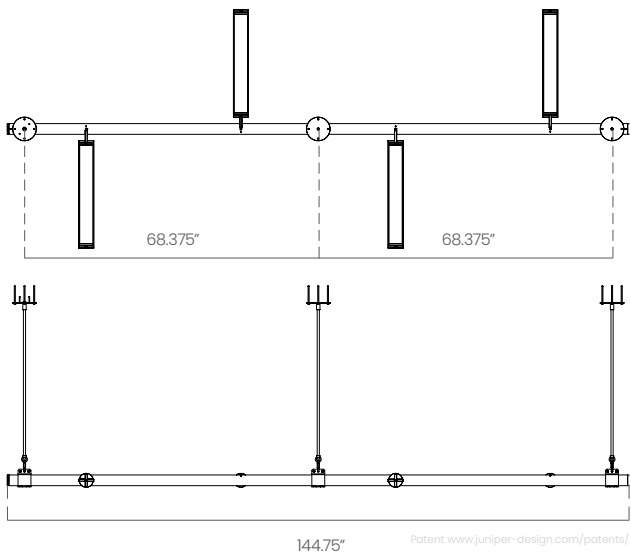

* All dimensions are in inches.
Drawings are not to scale.

Updated: 02/06/2024

STANDARD LAYOUTS
SUSPENSION TO SUSPENSION **STS1**

18 18 FT | 3 SECTIONS

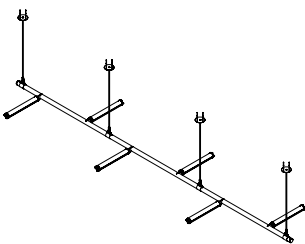

26 26 INCH LIGHT MODULE 36 36 INCH LIGHT MODULE

71.5 LBS | 1 POWER FEED 83 LBS | 2 POWER FEEDS

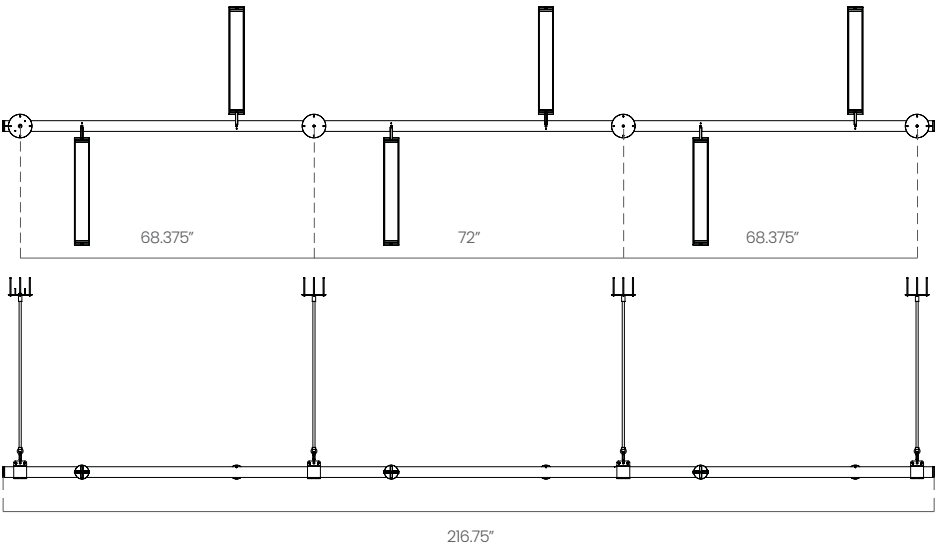

24 24 FT | 4 SECTIONS

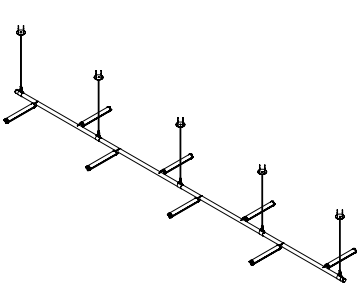

26 26 INCH LIGHT MODULE 36 36 INCH LIGHT MODULE

93 LBS | 1 POWER FEED 108.5 LBS | 2 POWER FEEDS

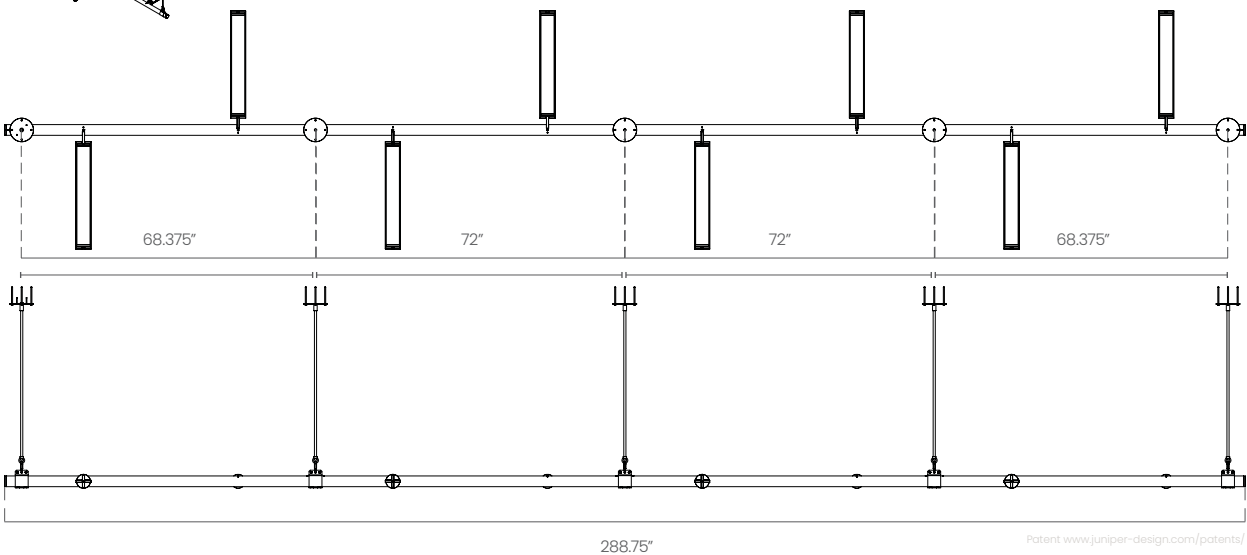

Updated: 02/06/2024

STANDARD LAYOUTS
SUSPENSION TO SUSPENSION STS1

18' STS1 Shown Below

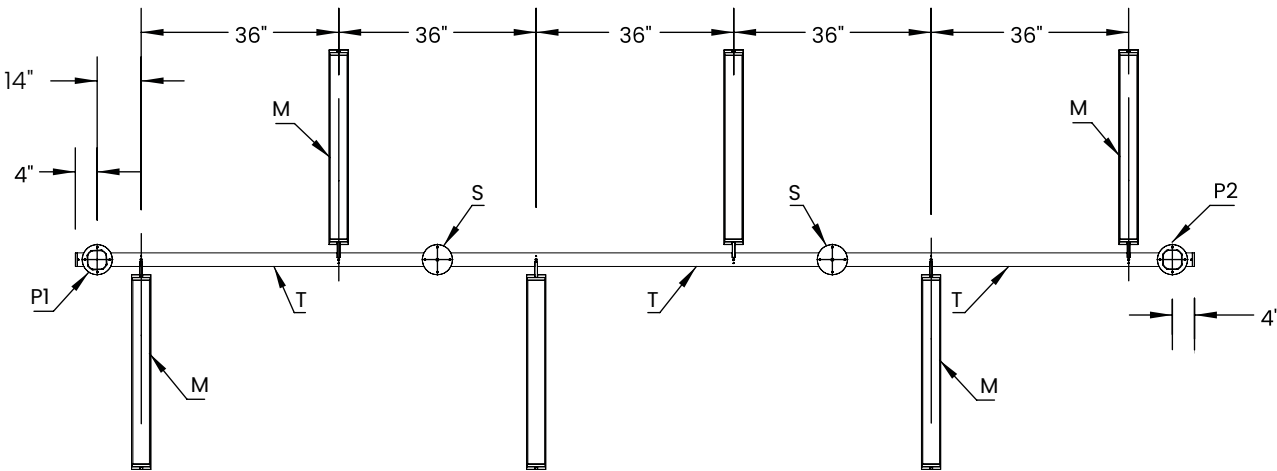

FIGURE 1A - TOP VIEW

Mounting point dimensions from center of ceiling mounting plate shown in Figure 1B.

- KEY
- POWERED HANGERS (P1/P2)

This hanger connects the fixture to the ceiling and powers the light modules.
- SUPPORT HANGERS (S)

These hangers support and connect the fixture to the ceiling. They are not powered.
- LIGHT MODULES (M)

Light modules are fastened and wired to the tubes.
- TUBE SECTIONS (T)

Light modules and hangers are connected to the tube sections. Sections also house wire harnesses to power the light modules.

* All dimensions are in inches.
Drawings are not to scale.

STANDARD LAYOUTS
SUSPENSION TO SUSPENSION STS1

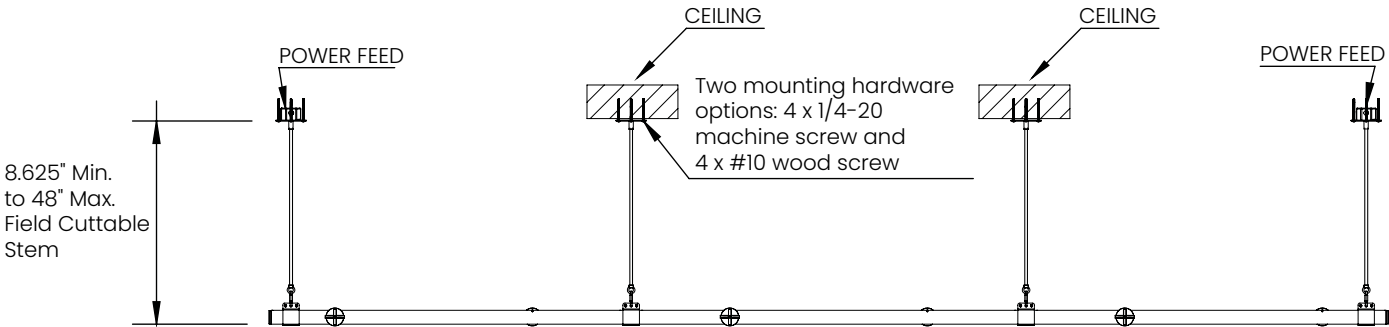

FIGURE 1B - SIDE VIEW

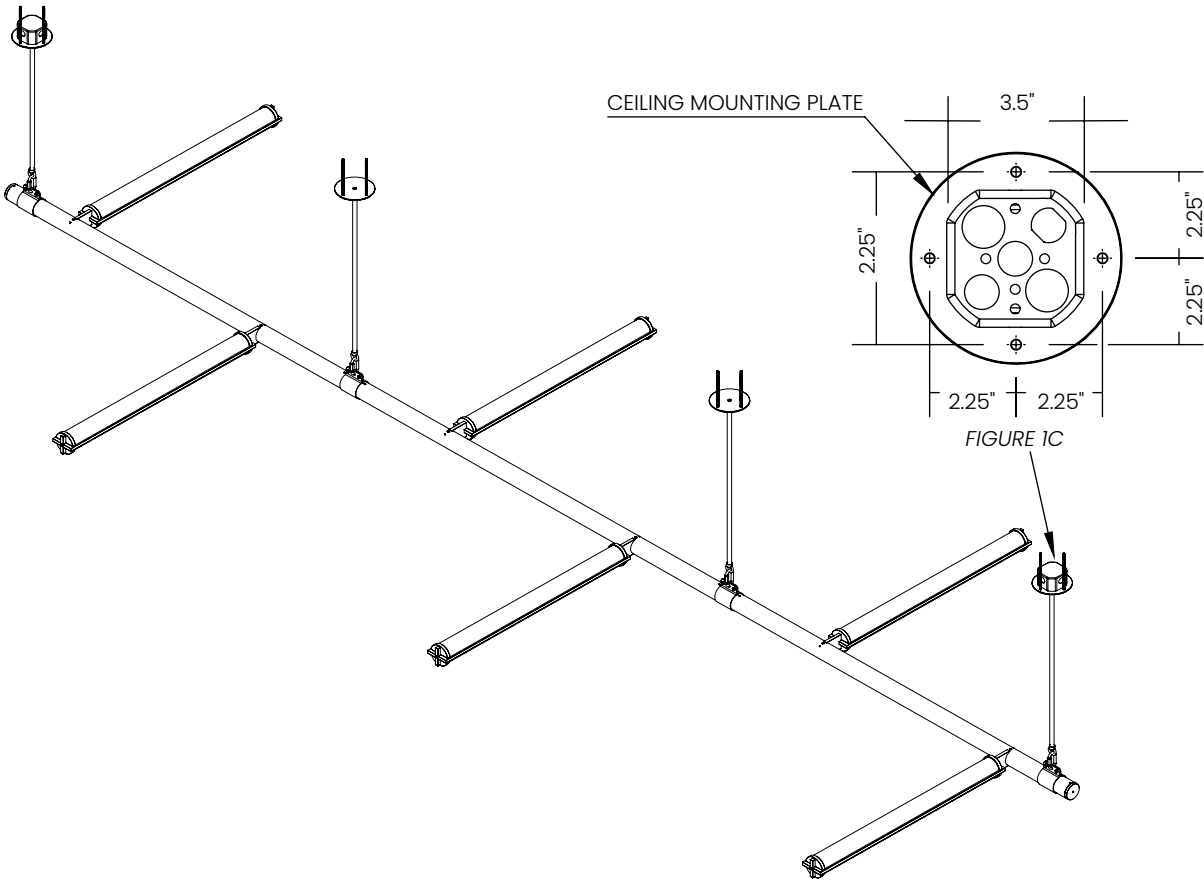
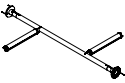

FIGURE 1C

*Junction box not included

STANDARD LAYOUTS
WALL TO WALL WTW1

06 6 FT | 1 SECTION



26 26 INCH LIGHT MODULE 36 36 INCH LIGHT MODULE

31 LBS | 1 POWER FEED 35 LBS | 1 POWER FEED

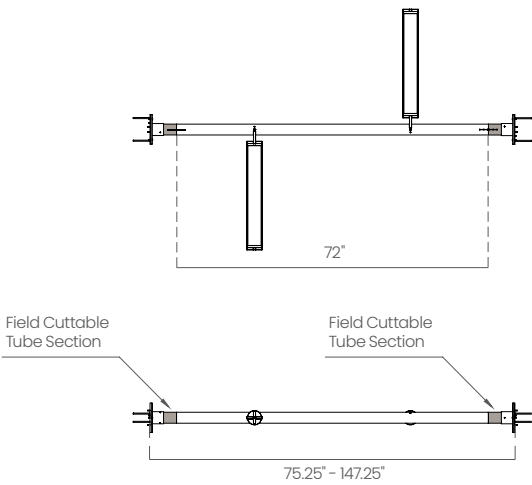

* Includes field cuttable extension section. See p. 21

12 12 FT | 2 SECTIONS

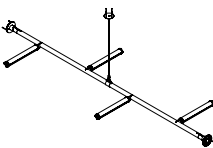

26 26 INCH LIGHT MODULE 36 36 INCH LIGHT MODULE

53 LBS | 1 POWER FEED 60.5 LBS | 1 POWER FEED

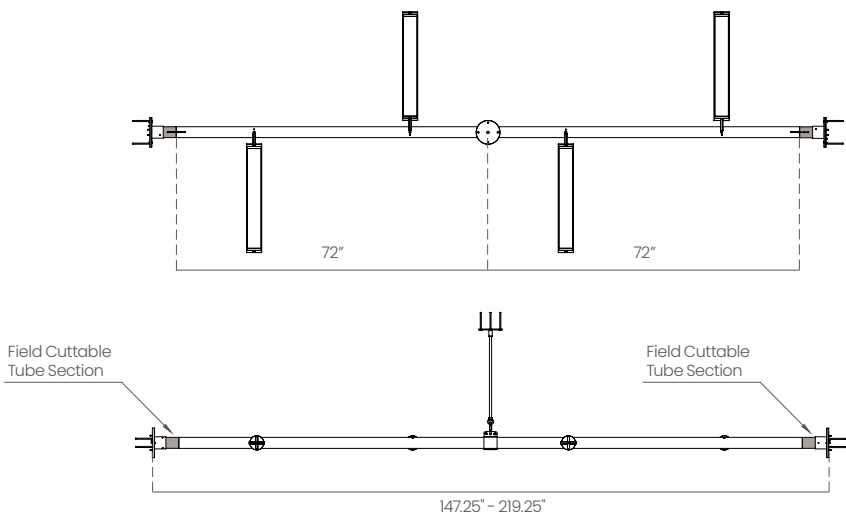

* Includes field cuttable extension section. See p. 21

STANDARD LAYOUTS
WALL TO WALL WTW1

18 18 FT | 3 SECTIONS

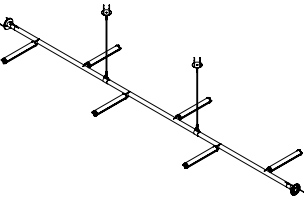

26 26 INCH LIGHT MODULE 36 36 INCH LIGHT MODULE

74.5 LBS | 1 POWER FEED 86 LBS | 2 POWER FEEDS

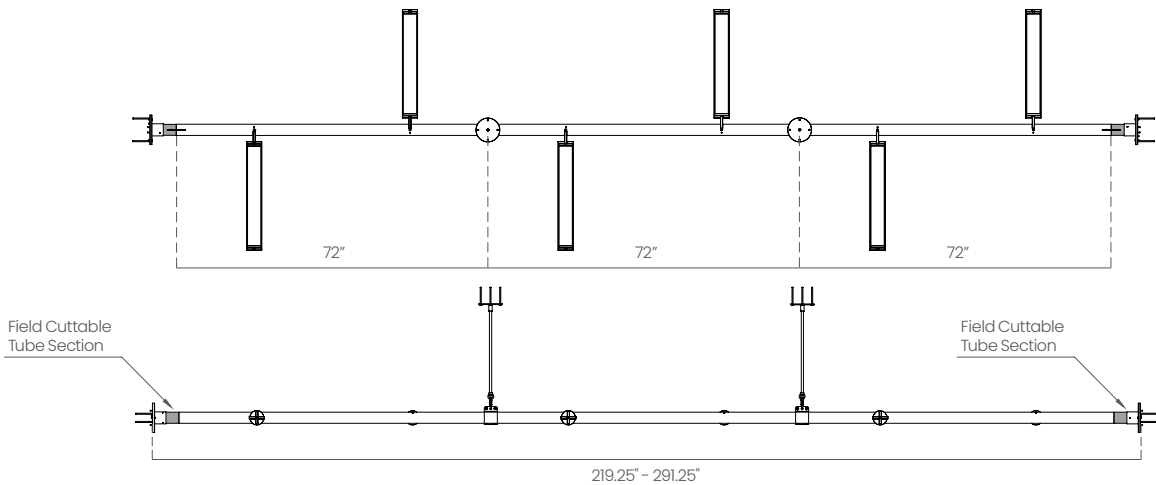

* Includes field cuttable extension section. See p. 21

24 24 FT | 4 SECTIONS

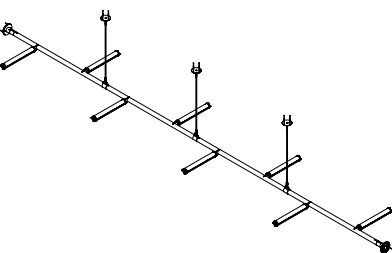

26 26 INCH LIGHT MODULE 36 36 INCH LIGHT MODULE

96.5 LBS | 1 POWER FEEDS 112 LBS | 2 POWER FEEDS

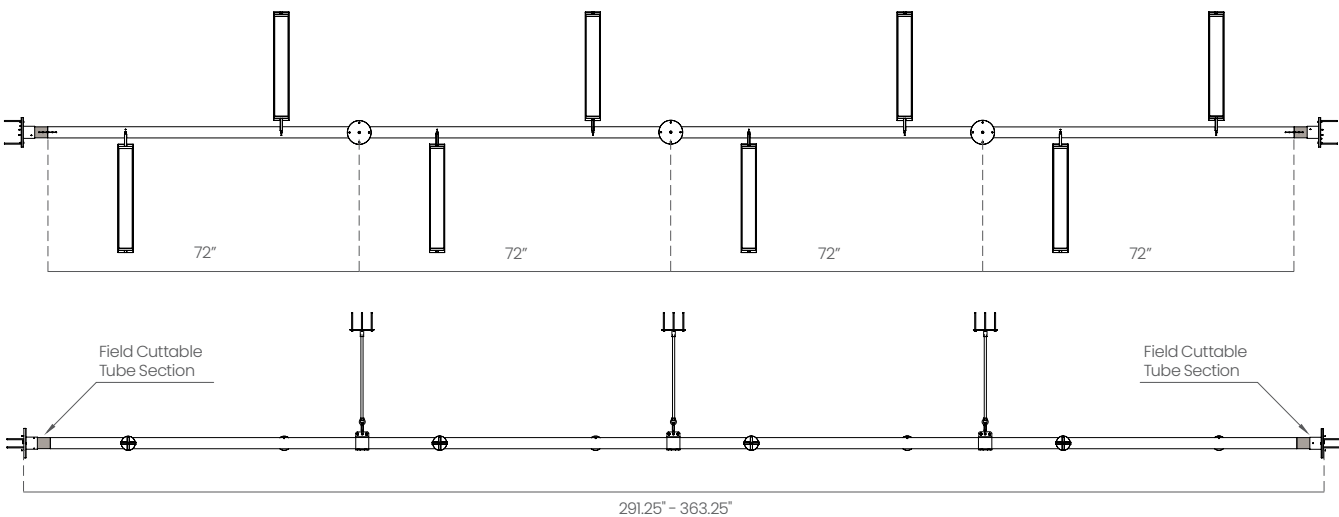

* Includes field cuttable extension section. See p. 21

18' WTW1 Shown Below

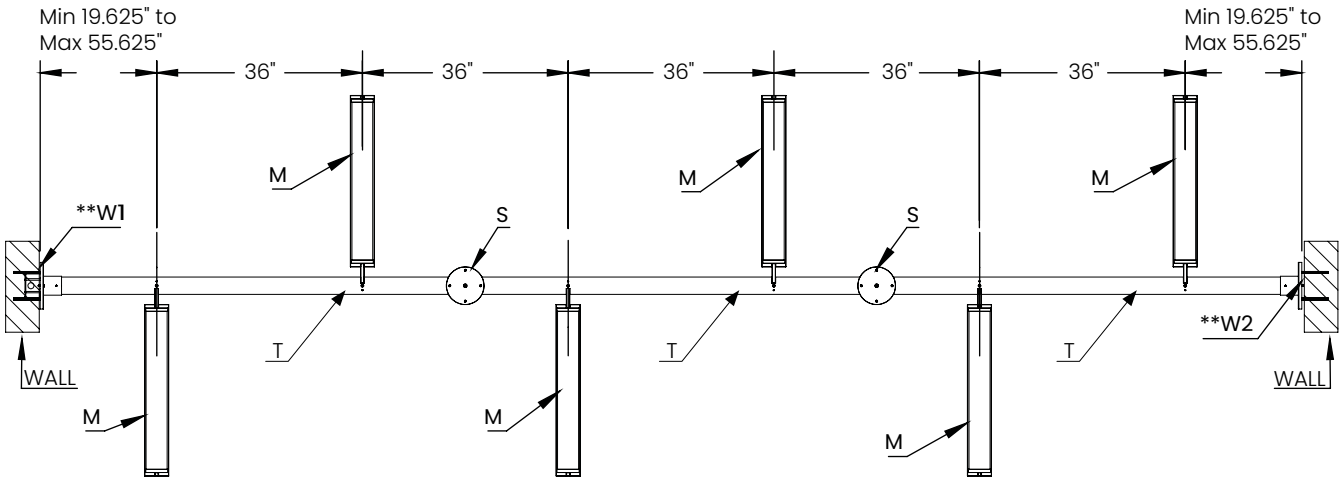

FIGURE 1A - TOP VIEW

Mounting point dimensions from center of ceiling mounting plate shown in Figure 1B.
Dimensions above are taken from center of hanger's ceiling mounting plate.
Mounting point dimensions for wall mount shown in figure 1C.

KEY	
WALL MOUNTS (W1, W2)	Wall mounts are used to connect, support and supply power to the fixture from the wall.
SUPPORT HANGERS (S)	These hangers support and connect the fixture to the ceiling. They are not powered.
LIGHT MODULES (M)	Light modules are fastened and wired to the tubes.
TUBE SECTIONS (T)	Light modules and hangers are connected to the tube sections. Sections also house wire harnesses to power the light modules.

* All dimensions are in inches.
Drawings are not to scale.

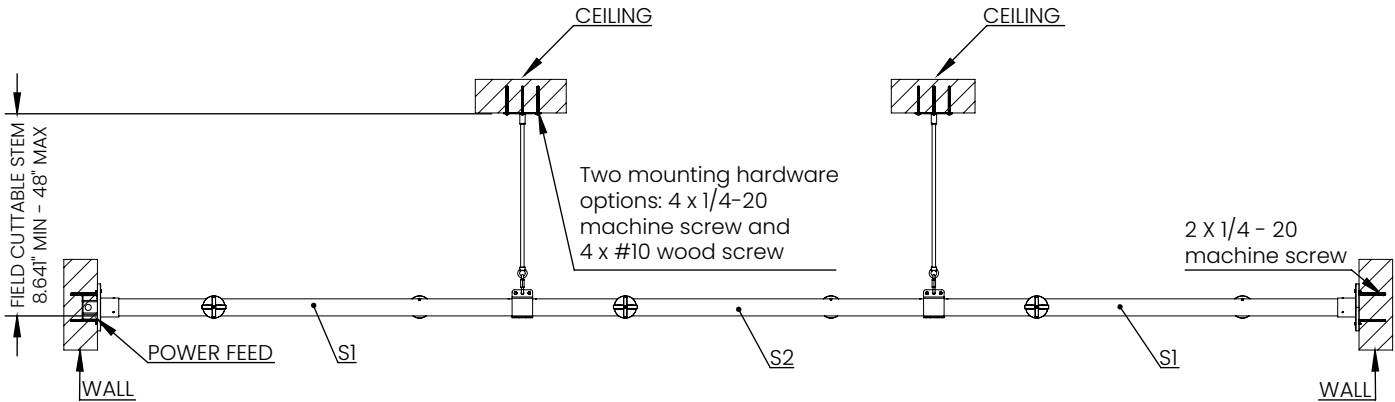

FIGURE 2 - SIDE VIEW

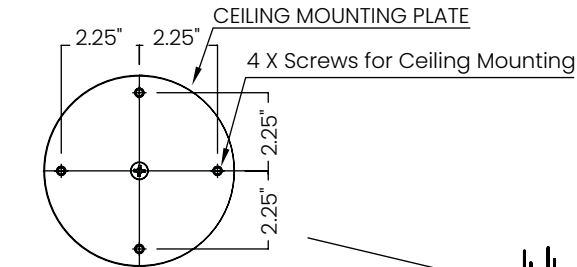

FIGURE 1C - SUPPORT HANGER

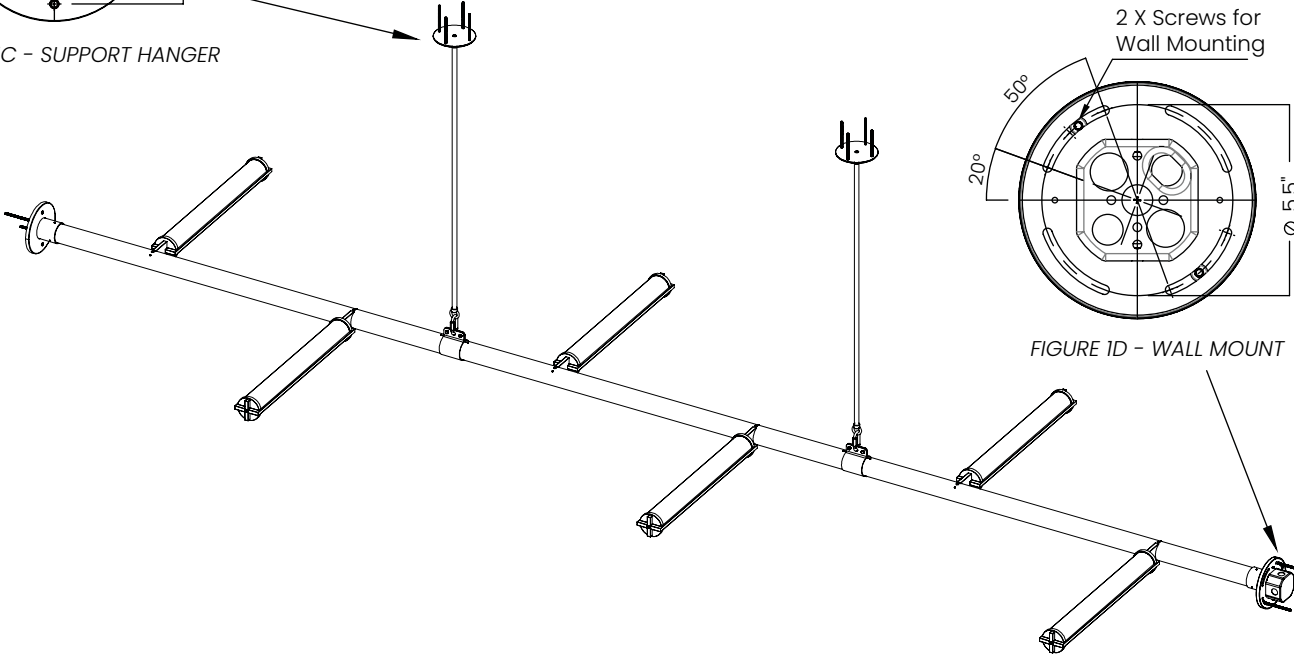
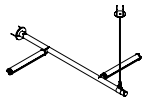

FIGURE 1D - WALL MOUNT

*Junction box not included

STANDARD LAYOUTS
WALL TO SUSPENSION WTS1

06 6 FT | 1 SECTION



26 26 INCH LIGHT MODULE	36 36 INCH LIGHT MODULE
25.5 LBS 1 POWER FEED	29.5 LBS 1 POWER FEED

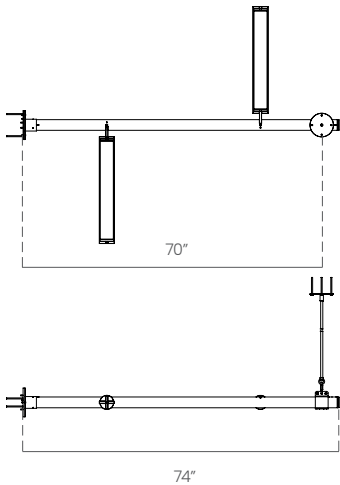

12 12 FT | 2 SECTIONS

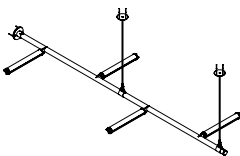

26 26 INCH LIGHT MODULE	36 36 INCH LIGHT MODULE
47.5 LBS 1 POWER FEED	55 LBS 1 POWER FEED

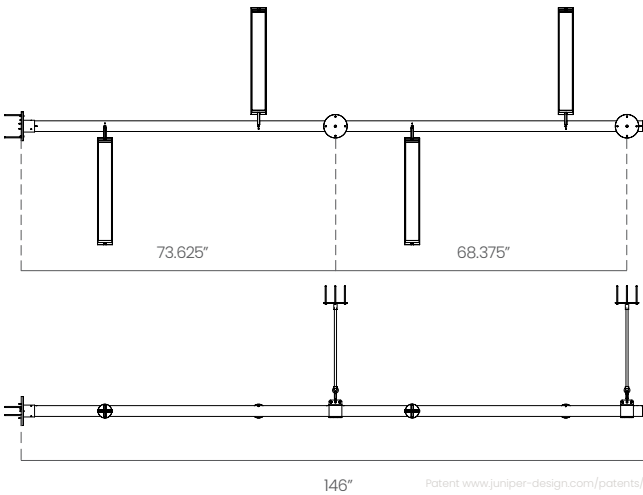

* All dimensions are in inches.
Drawings are not to scale.

STANDARD LAYOUTS
WALL TO SUSPENSION WTS1

18 18 FT | 3 SECTIONS

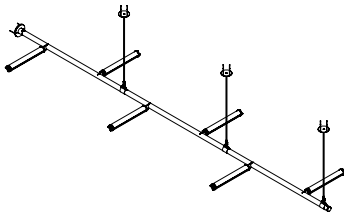

26 26 INCH LIGHT MODULE	36 36 INCH LIGHT MODULE
69 LBS 1 POWER FEED	80.5 LBS 2 POWER FEEDS

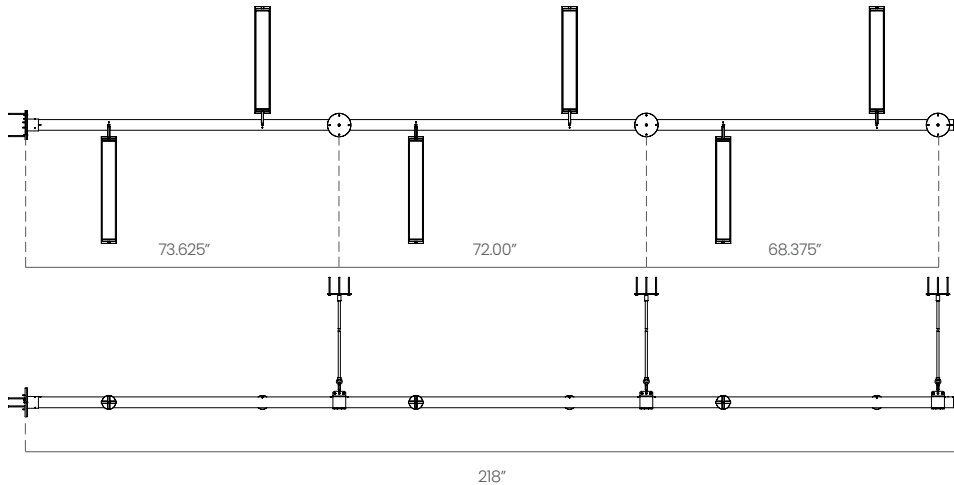

24 24 FT | 4 SECTIONS

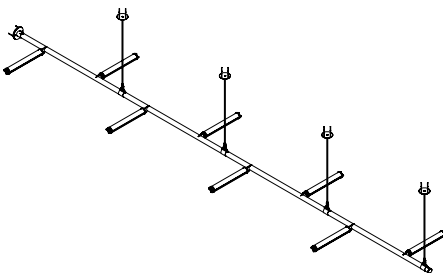

26 26 INCH LIGHT MODULE	36 36 INCH LIGHT MODULE
90.5 LBS 1 POWER FEED	106 LBS 2 POWER FEEDS

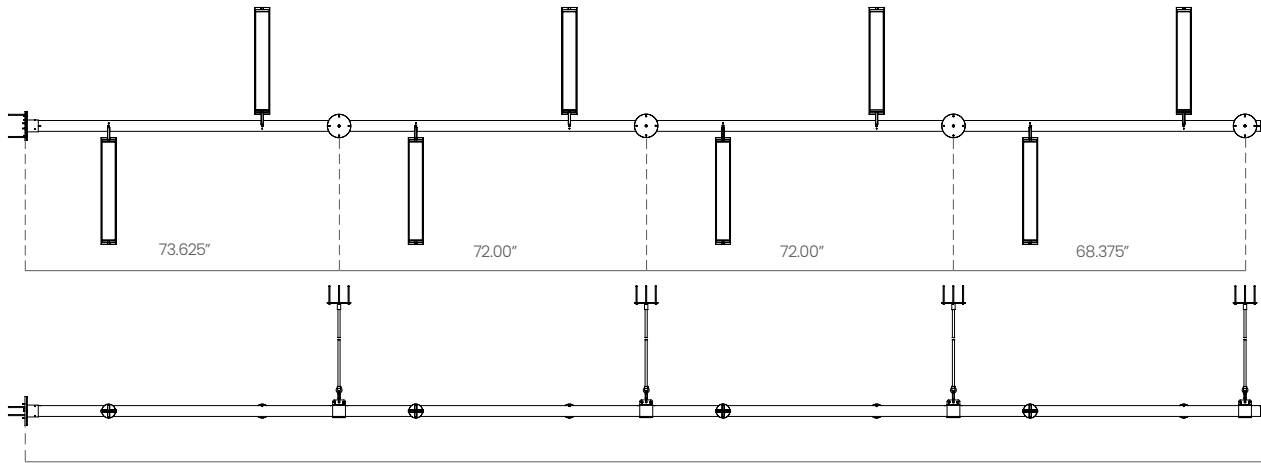

STANDARD LAYOUTS
WALL TO SUSPENSION WTS1

12' WTS1 Shown Below

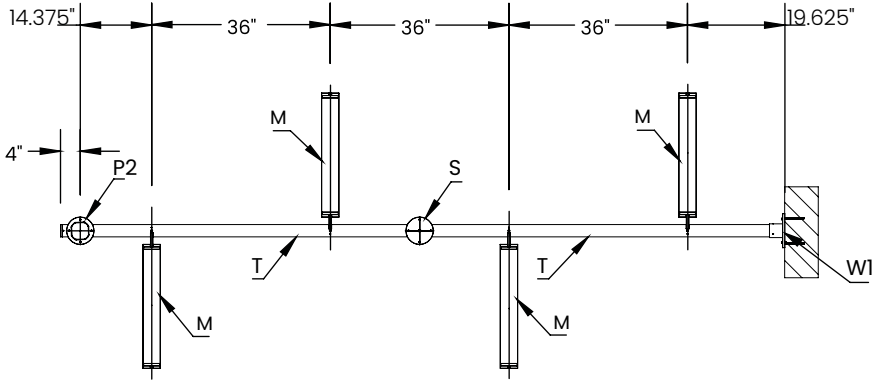

FIGURE 1A - TOP VIEW

Mounting point dimensions from center of ceiling mounting plate shown in Figure 1B.

KEY	
POWERED HANGERS (P2)	This hanger connects the fixture to the ceiling and powers the light modules.
SUPPORT HANGERS (S)	These hangers support and connect the fixture to the ceiling. They are not powered.
LIGHT MODULES (M)	Light modules are fastened and wired to the tubes.
WALL MOUNTS (W1)	Wall mounts are used to connect, support and supply power to the fixture from the wall.
TUBE SECTIONS (T)	Light modules and hangers are connected to the tube sections. Sections also house wire harnesses to power the light modules.

*All dimensions are in inches.
Drawings are not to scale.

STANDARD LAYOUTS
WALL TO SUSPENSION WTS1

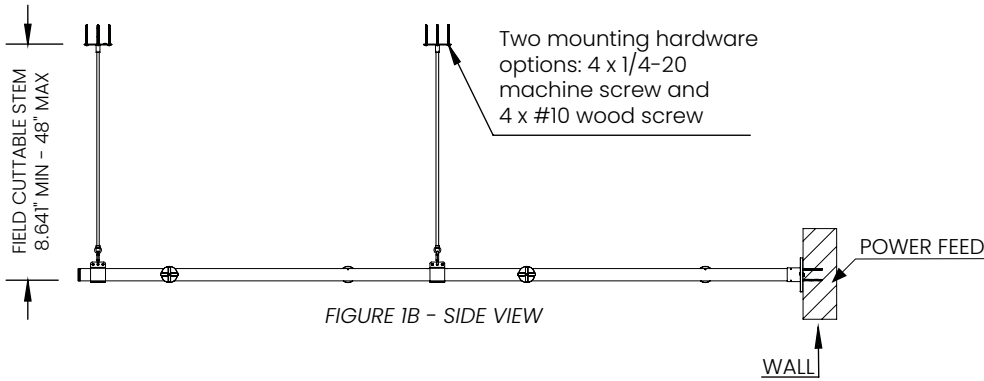

FIGURE 1B - SIDE VIEW

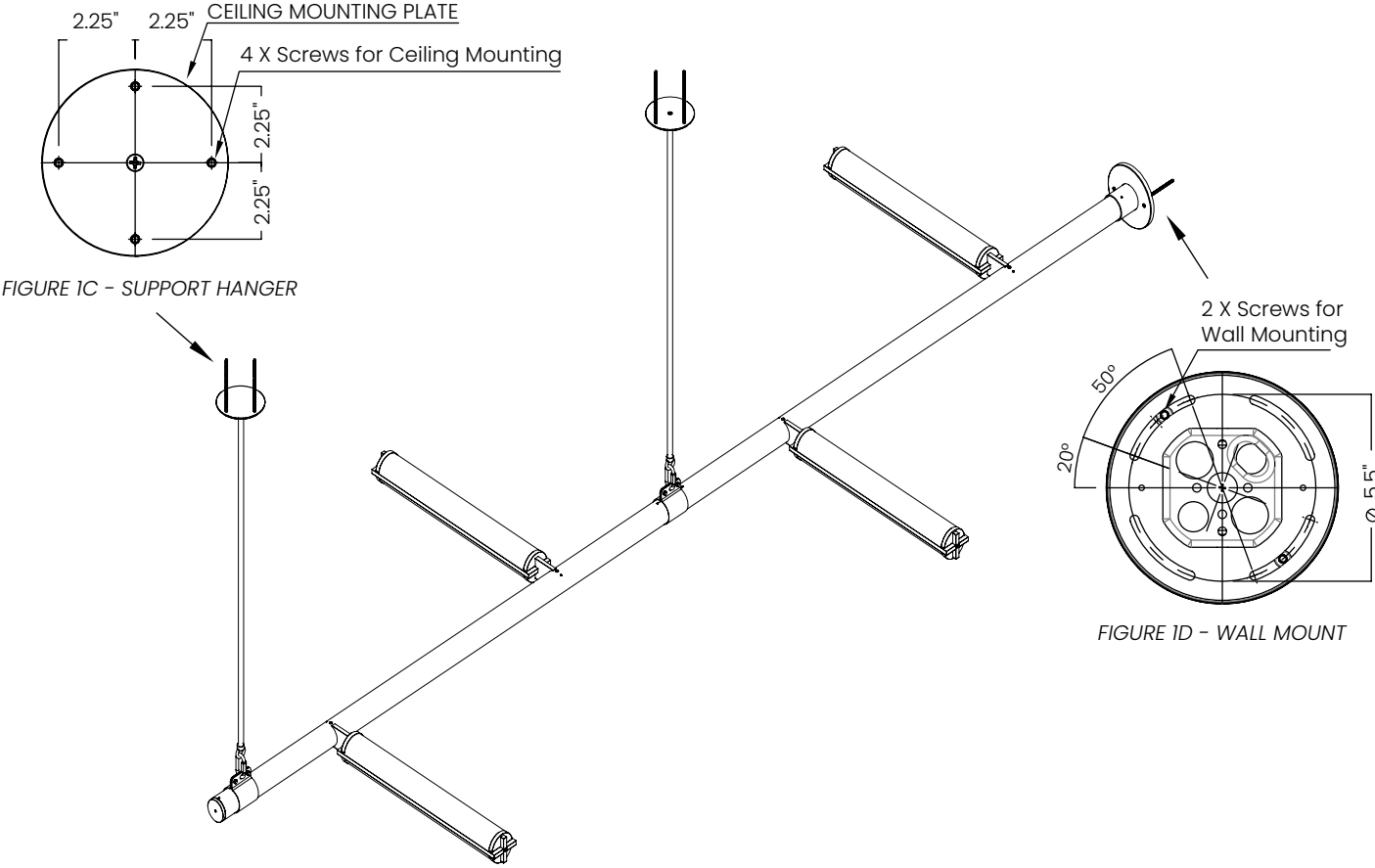
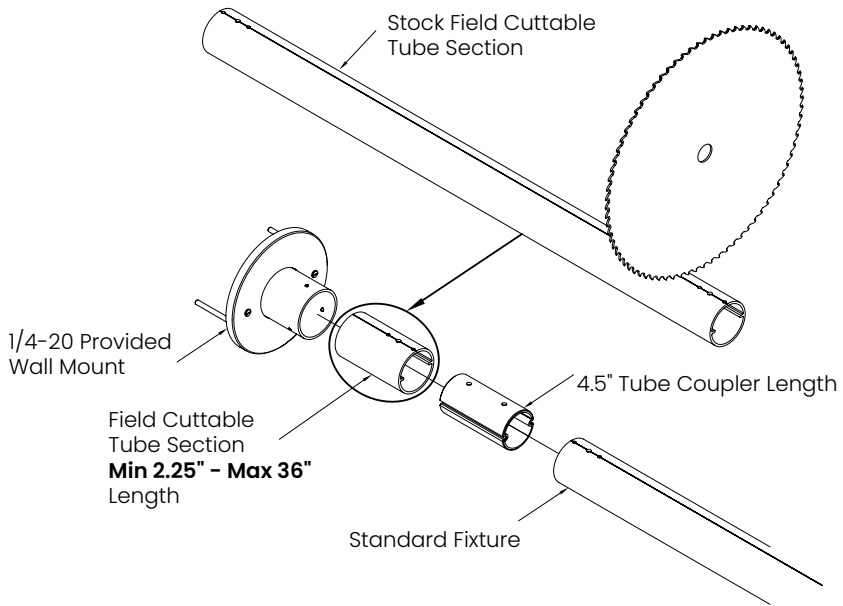

FIGURE 1C - SUPPORT HANGER

FIGURE 1D - WALL MOUNT

*Junction box not included

STANDARD LAYOUTS
FIELD CUTTABLE TUBE SECTION WTW1



*Junction box not included and use of field cuttable tube section is optional

06 6 FT | 1 SECTION

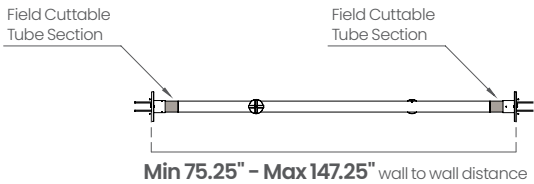

12 12 FT | 2 SECTIONS

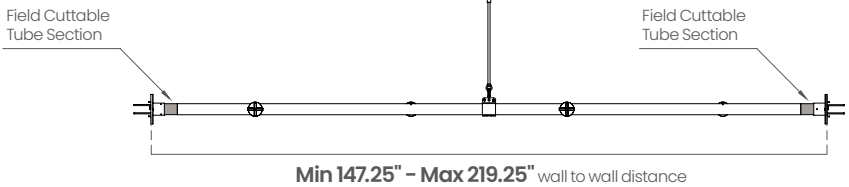

18 18 FT | 3 SECTIONS

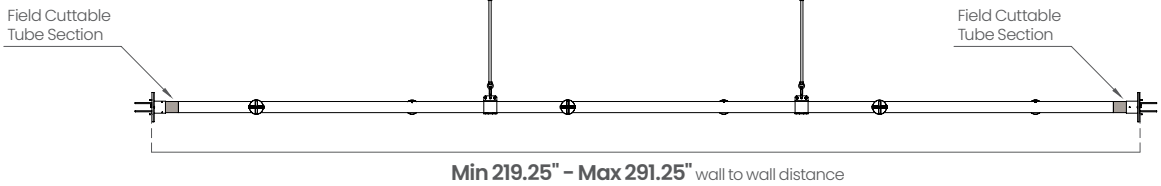

24 24 FT | 4 SECTIONS

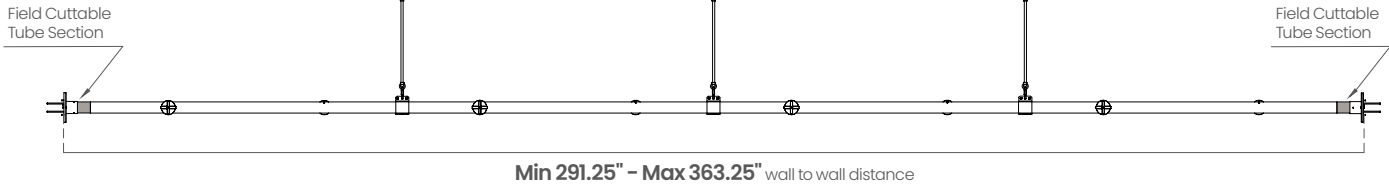

* All dimensions are in inches.
Drawings are not to scale.

STANDARD LAYOUTS
LIGHT MODULE 26 | 36

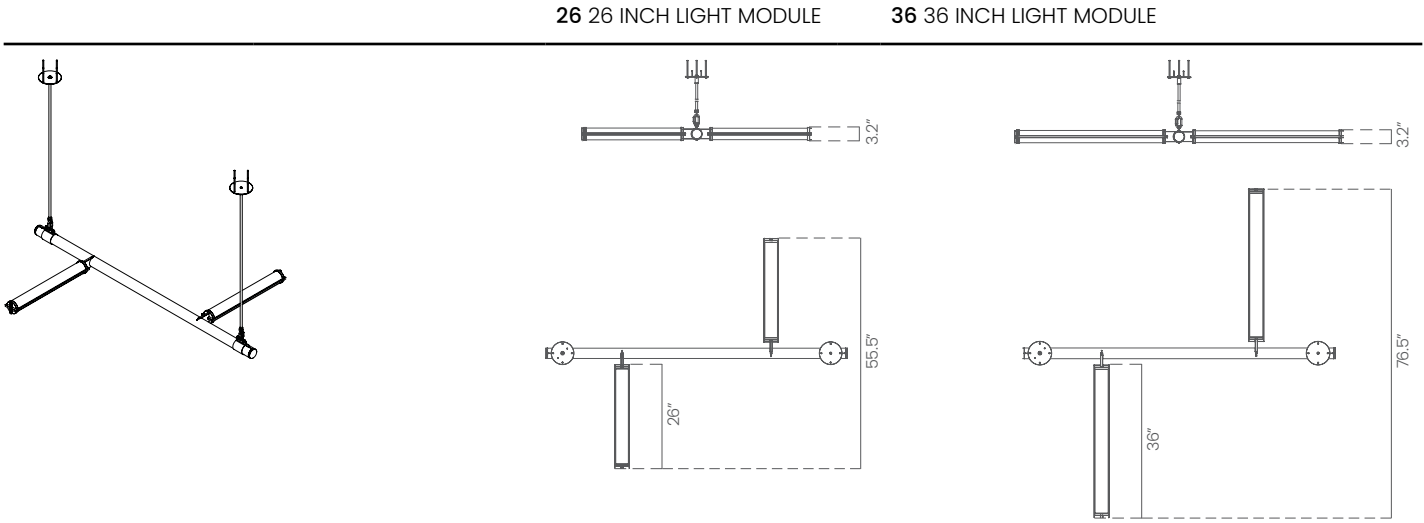

STS1 SUSPENSION TO SUSPENSION	26 26 INCH LIGHT MODULE	36 36 INCH LIGHT MODULE
06 6 ft 1 section	28 LBS 1 POWER FEED	32 LBS 1 POWER FEED
12 12 ft 2 sections	50 LBS 1 POWER FEED	57.5 LBS 1 POWER FEED
18 18 ft 3 sections	71.5 LBS 1 POWER FEED	83 LBS 2 POWER FEEDS
24 24 ft 4 sections	93 LBS 2 POWER FEEDS	108.5 LBS 2 POWER FEEDS
WTW1 WALL TO WALL	26 26 INCH LIGHT MODULE	36 36 INCH LIGHT MODULE
06 6 ft 1 section	31 LBS 1 POWER FEED	35 LBS 1 POWER FEED
12 12 ft 2 sections	53 LBS 1 POWER FEED	60.5 LBS 1 POWER FEED
18 18 ft 3 sections	74.5 LBS 1 POWER FEED	86 LBS 2 POWER FEEDS
24 24 ft 4 sections	96.5 LBS 2 POWER FEEDS	112 LBS 2 POWER FEEDS
WTS1 WALL TO SUSPENSION	26 26 INCH LIGHT MODULE	36 36 INCH LIGHT MODULE
06 6 ft 1 section	25.5 LBS 1 POWER FEED	29.5 LBS 1 POWER FEED
12 12 ft 2 sections	47.5 LBS 1 POWER FEED	55 LBS 1 POWER FEED
18 18 ft 3 sections	69 LBS 1 POWER FEED	80.5 LBS 2 POWER FEEDS
24 24 ft 4 sections	90.5 LBS 2 POWER FEEDS	106 LBS 2 POWER FEEDS

SYSTEM SPECIFICATIONS
SYSTEM AND DRIVER MATRIX STS1 WTW1 WTS1

SIZE OF LIGHT MODULE (IN)	OVERALL LENGTH (FT)	NO. OF LIGHT MODULES	TOTAL WATTS (W)	NO. OF DRIVERS	WATTAGE / DRIVER (W)	NO. OF POWER FEEDS	TOTAL DRIVER WATTAGE (W)
26	6 FT 1 SECTION	2	71.6	2	60	1	120
	12 FT 2 SECTIONS	4	143.2				192
	18 FT 3 SECTIONS	6	214.8	4	96		384
	24 FT 4 SECTIONS	8	286.4				384
36	6 FT 1 SECTION	2	107.6	2	60	1	120
	12 FT 2 SECTIONS	4	215.2	4			240
	18 FT 3 SECTIONS	6	322.8	6		2	360
	24 FT 4 SECTIONS	8	430.4	8			480

Notes:

2 conductors required per driver, per fixture

14 AWG feeder cable recommended

Direct / Indirect or Unison dimming does not change driver requirements

SYSTEM SPECIFICATIONS
POWER SUPPLY

- The METROPOLIS System power supplies are 120–277 V AC input, forward-phase, reverse-phase, and 0–10 V dimming to 1% in one package
- UL Listed power supplies are available for remote applications
- Use chart to determine the best wattage for the required layout and run length

ITEM	PART NUMBER	WATTAGE	INPUT VOLTAGE	DIMMING
POWER SUPPLY 24 VDC, TRIAC/ELV/0-10 V 1% DIMMING, REMOTE, UL LISTED				
	JPR-PWR-0128	60 W	120–277 V AC	FORWARD PHASE, REVERSE PHASE, 0-10 V TO 1%
	JPR-PWR-0129	96 W		

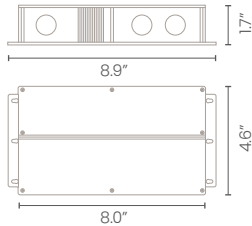

LOCATING THE REMOTE POWER SUPPLIES

Remote power supplies are typically located within 50' of the power feed, in an accessible location. Minimum 14 AWG feeder cable recommended (supplied by electrician)– voltage drop calculations by electrician.

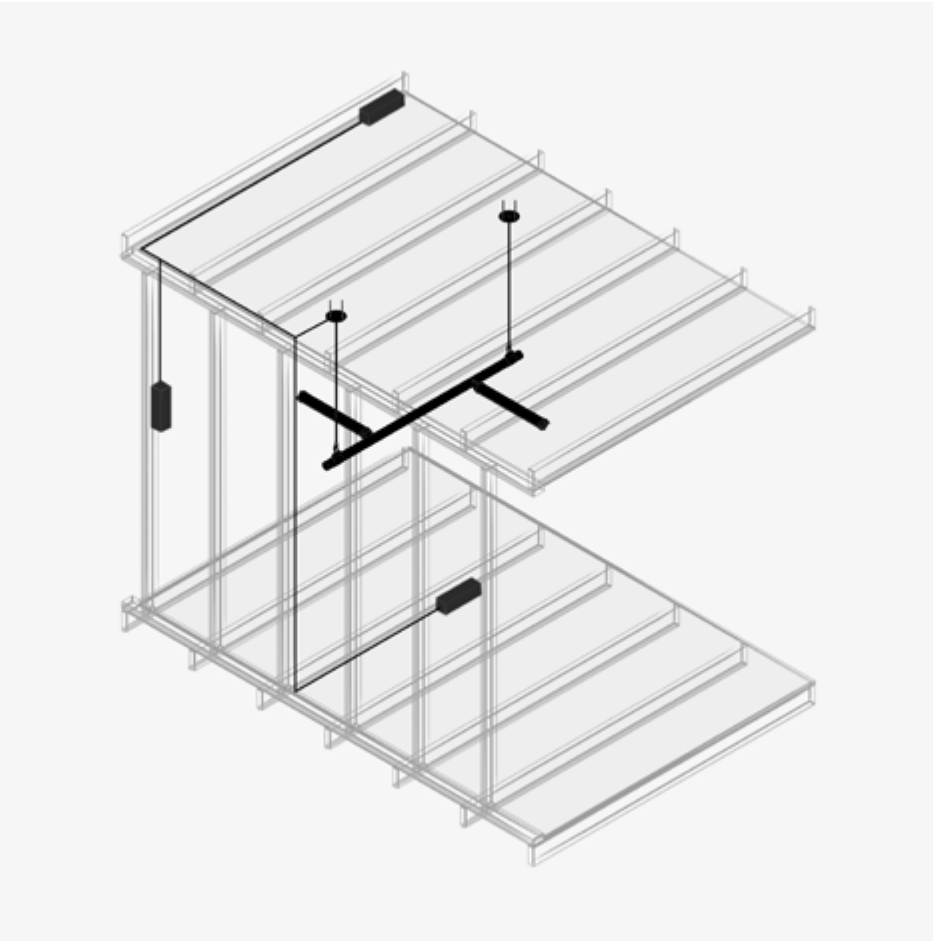

SYSTEM SPECIFICATIONS
WIRING DIAGRAMS 6 FT | 1 SECTION STS1 WTW1 WTS1

26" AND 36" LIGHT MODULES

0-10 V Direct/Indirect Dimming

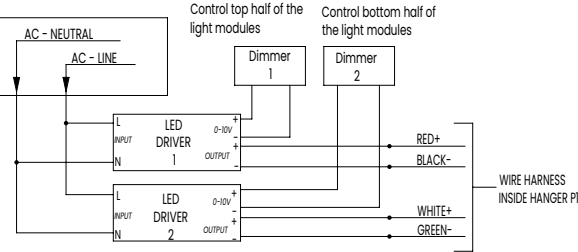

0-10 V Unison Dimming

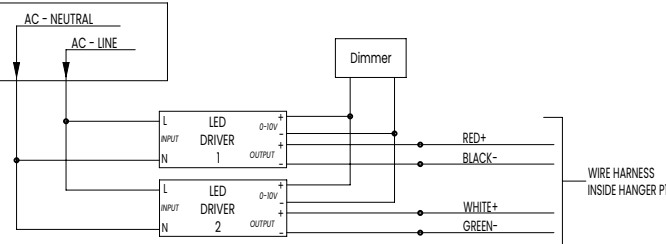

ELV/Triac Direct/Indirect Dimming

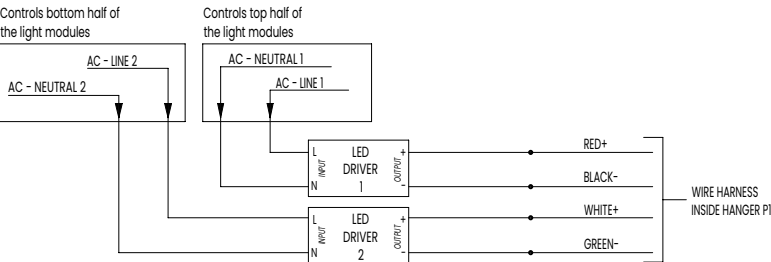

ELV/Triac Unison Dimming

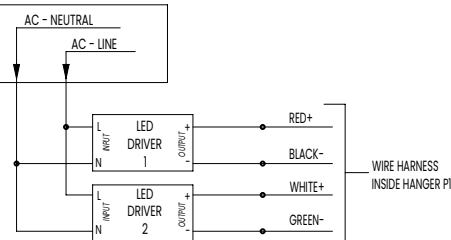

SYSTEM SPECIFICATIONS
WIRING DIAGRAMS 12 FT | 2 SECTIONS STS1 WTW1 WTS1

26" LIGHT MODULES

0-10 V Direct/Indirect Dimming

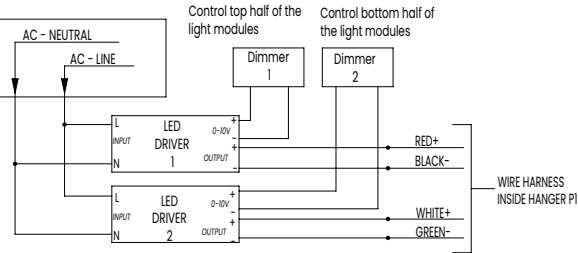

0-10 V Unison Dimming

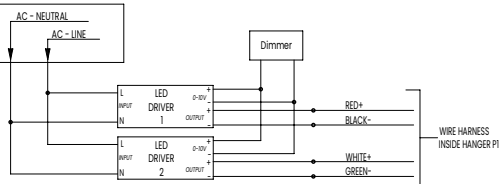

ELV/Triac Direct/Indirect Dimming

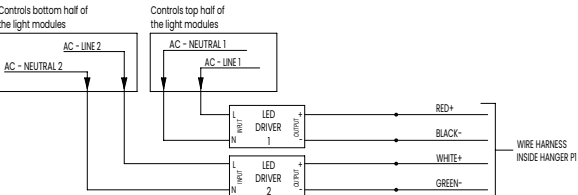

ELV/Triac Unison Dimming

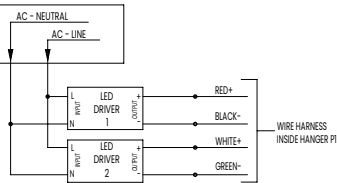

36" LIGHT MODULES

0-10 V Direct/Indirect Dimming

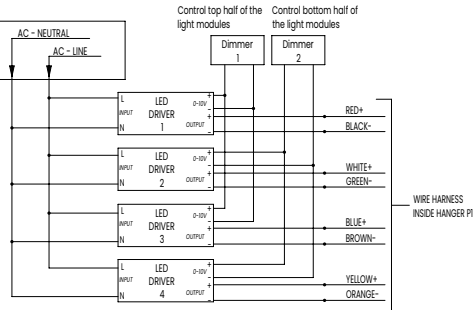

0-10 V Unison Dimming

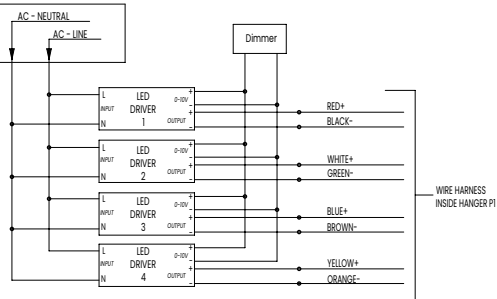

ELV/Triac Direct/Indirect Dimming

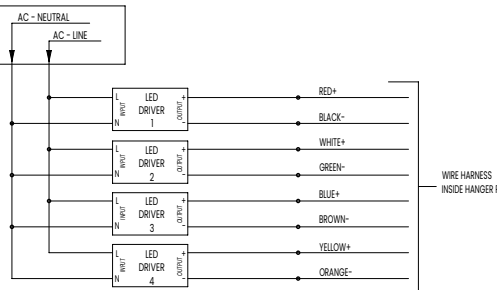

ELV/Triac Unison Dimming

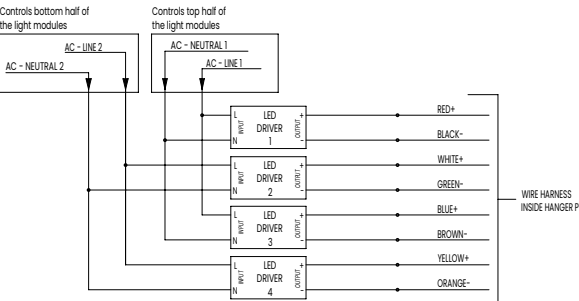

SYSTEM SPECIFICATIONS
WIRING DIAGRAMS 18 FT | 3 SECTIONS STS1 WTW1 WTS1

26" LIGHT MODULES

0-10 V Direct/Indirect Dimming

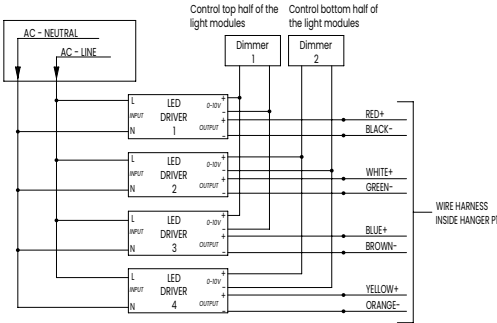

0-10 V Unison Dimming

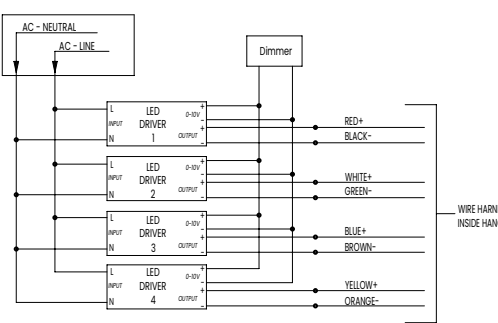

ELV/Triac Direct/Indirect Dimming

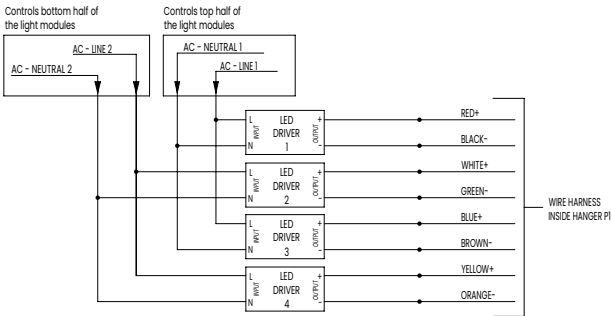

ELV/Triac Unison Dimming

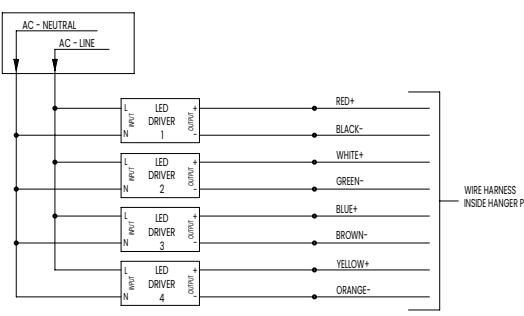

36" LIGHT MODULES

0-10 V Direct/Indirect Dimming

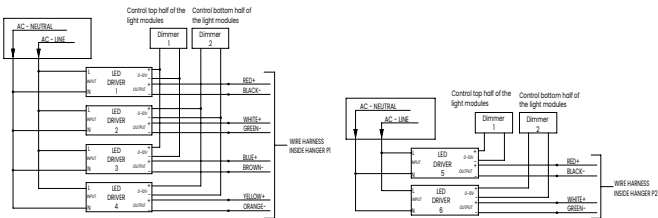

ELV/Triac Direct/Indirect Dimming

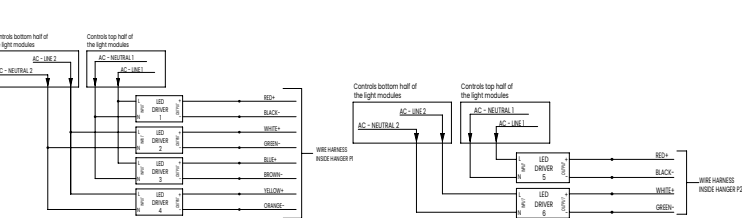

0-10 V Unison Dimming

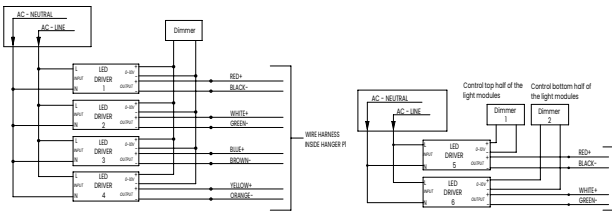

ELV/Triac Unison Dimming

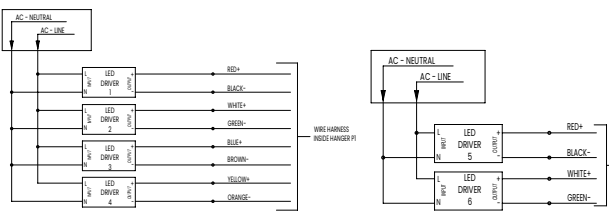

SYSTEM SPECIFICATIONS
WIRING DIAGRAMS 24 FT | 4 SECTIONS STS1 WTW1 WTS1

26" LIGHT MODULES

0-10 V Direct/Indirect Dimming

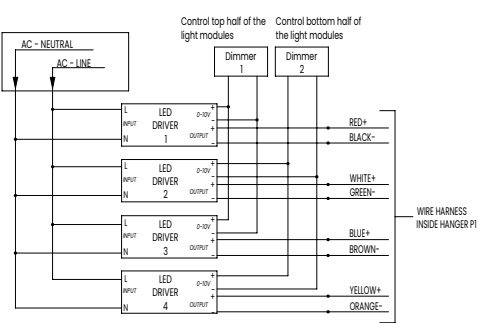

0-10 V Unison Dimming

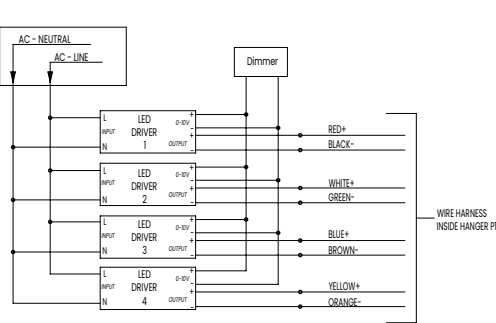

ELV/Triac Direct/Indirect Dimming

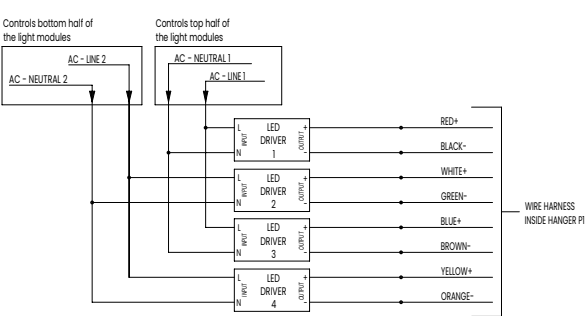

ELV/Triac Unison Dimming

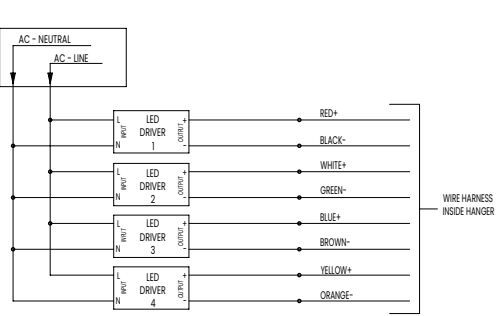

36" LIGHT MODULES

0-10 V Direct/Indirect Dimming

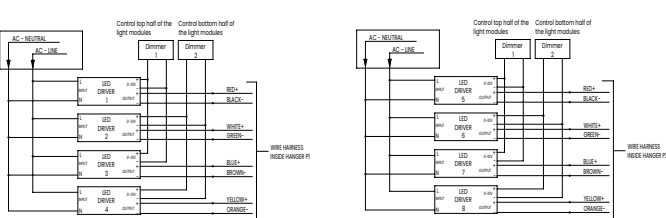

ELV/Triac Direct/Indirect Dimming

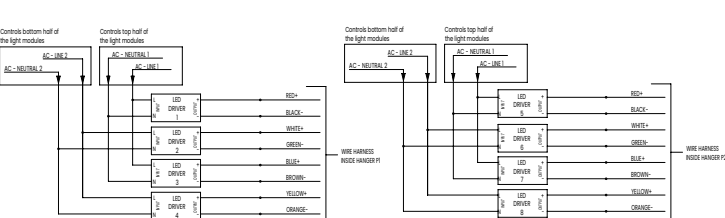

0-10 V Unison Dimming

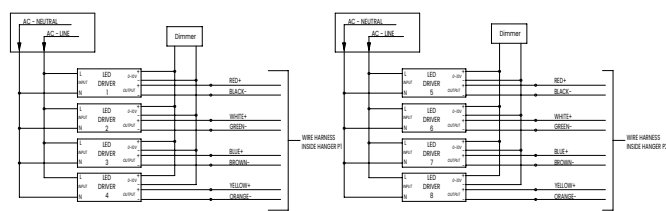

ELV/Triac Unison Dimming

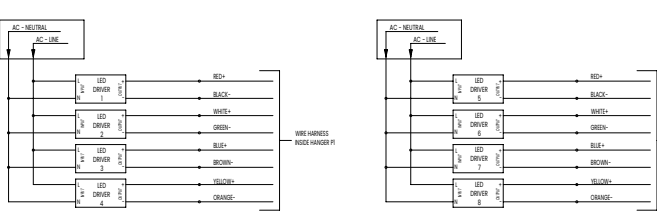

SYSTEM SPECIFICATIONS
PHOTOMETRICS DATA
TM-30 REPORTS | COLOR QUALITY

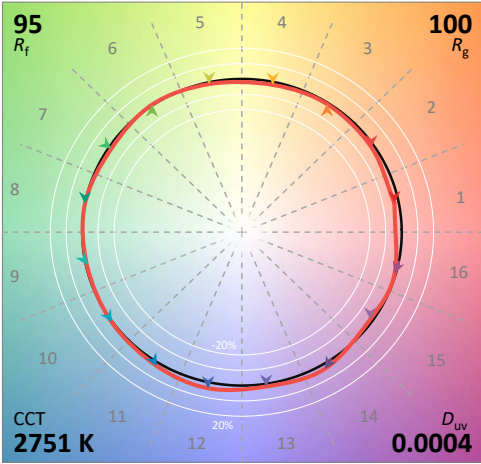

2700K

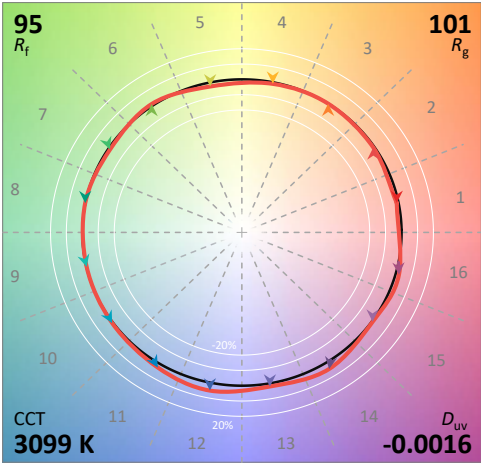

3000K

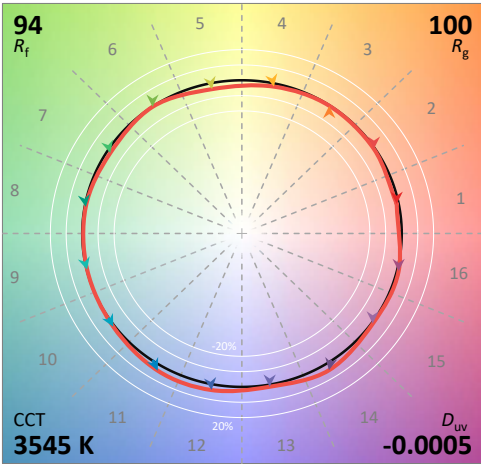

3500K

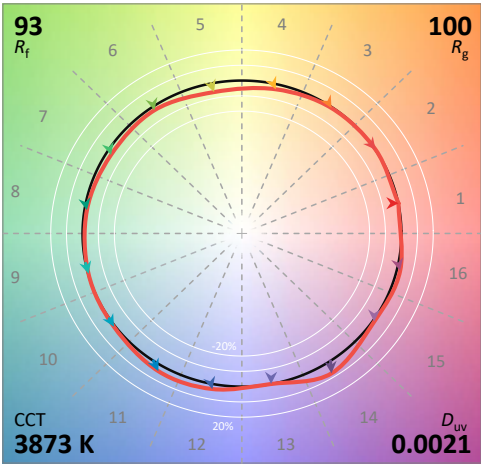

4000K

SYSTEM SPECIFICATIONS
HEXAGONAL MESH DETAILS

Material: Steel

Finish: Black

Gauge: 22 (0.031")

Hole Size: 0.25"

Open Area: 79%

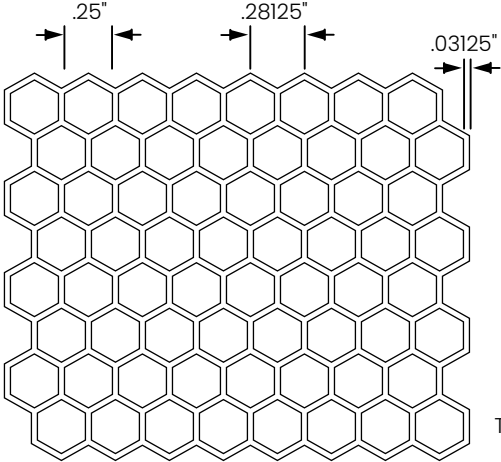
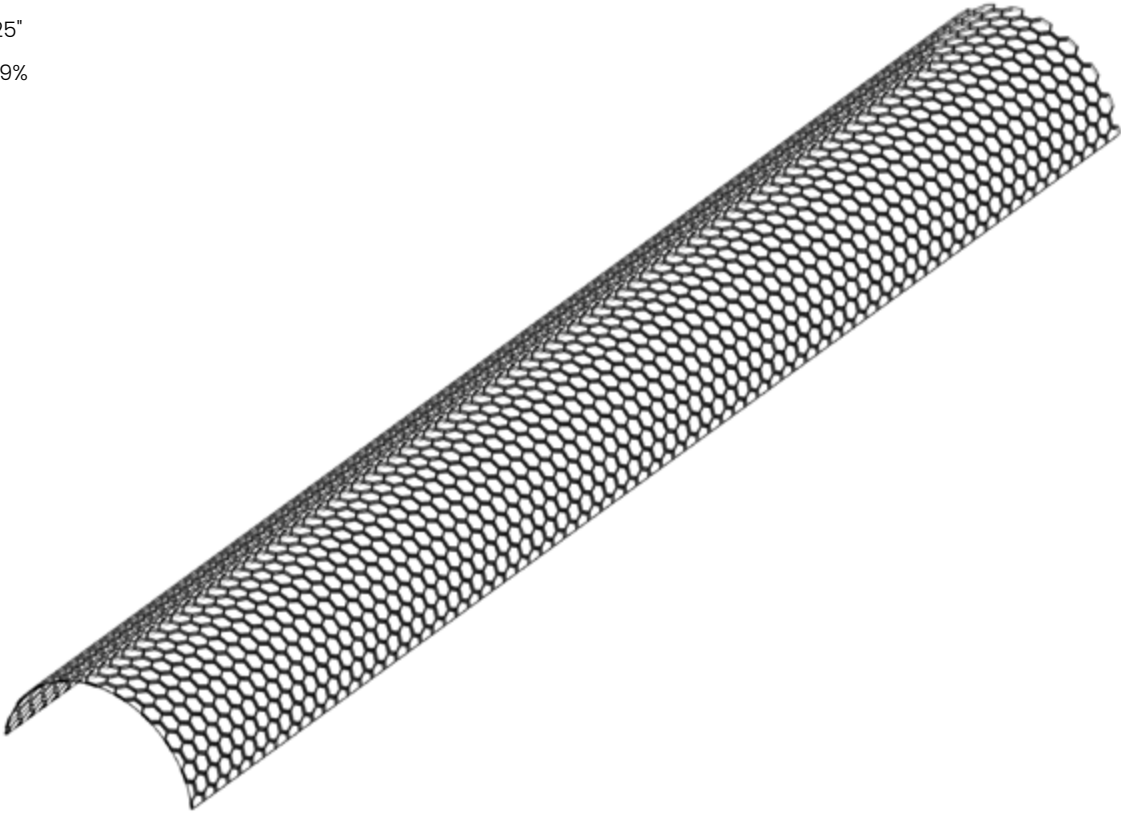

1:1 Scale | Hexagonal Mesh

* All dimensions are in inches.
Drawings are not to scale.



SYSTEM SPECIFICATIONS

FINISHES



14 Satin Brass | Satin Black Trims



16 Satin Black | Satin Black Trims



18 Satin Aluminum | Satin Black Trims



19 Polished Aluminum | Polished Aluminum Trims



42 Satin Aluminum | Satin Aluminum Trims