

# PERFORMANCES

## 1 EAST STOREFRONT

### history of walking

James Ijames

Friday @ 7:10, Saturday @ 7:10  
(Full Length)

In the midst of a presidential election, the messiah returns, bombs explode, and a conservative radio host becomes a prophet. *Supported by the National New Play Network in partnership with Kitchen Dog Theater (Dallas) & InterAct Theatre Company (Philadelphia).*

Director: Beth Wood

Performers: Davis Aguila, Ashley Aquilla, Leilani Barrett, Ryan Edlinger, Doug Kusak, Abraham McNeil Adams, Mary-Francis Renee Miller

### The Mint Play

William James Burke

Thursday @ 7:10 (Full Length)

An absurdist piece inspired by the chaos theory, *The Mint Play* is a series of strange loops—people reaching, craving, embarking, and closing loops of connection.

Director: Ismael Lara

Performers: Samantha A. Camp, Brianna DeRosa, Gordon Hinchin, Lynna Metrisin, Jackson Pollock, Meredith Aleigha Wells, Marc Zeale

## 2 FEFU'S KITCHEN

### When the She'll Broke

Faye Hargate

Friday @ 7:30, Saturday @ 7:30  
(ongoing 7:30-9:00)

A brief glimpse inside an ongoing performance research project exploring American female identity.

Director & Designer: Faye Hargate

Assistant Designer: Joan Hargate

Performers: Krystal Sierra, Dezhana Simmons, Anastasia Urozhaeva

Special Thanks: Raymond Bobgan

## 3 STOREFRONT STUDIO

### Emergence

Molly Andrews-Hinders

Thursday @ 9:10, Friday @ 7:15,  
Saturday @ 7:15

*Emergence* calls us to question the way we challenge limiting beliefs. How do we become our own heroes and set ourselves free?

Composer & Music Director:

Molly Andrews-Hinders

Performers: Kristy Cruz, Colleen McCaughey

Guitarist: Mo Dugger

### Everything is okay (and other helpful lies)

Melissa Crum & Caitlin Lewins,  
16/17 Nord Family Foundation  
Catapult Fellows

Thursday @ 7:15, Friday @ 8:00  
(Full Length)

In this dark musical comedy, friendships are challenged, buddies die, and everybody drinks. Cheers.

Music Director: Tim Moon

Performers: Luke Brett, Roderick S. Cardwell II, Melissa Crum, Madelyn Hayes, Elizabeth Kelly, Caitlin Lewins

### The Mint Play

William James Burke

Saturday @ 8:00 (Full Length)

See Stage 1: East Storefront for full description.

## 4 CABARET

### Fingers and Toes

Renee Schilling

Thursday @ 9:30, Friday @ 8:20 &  
9:20, Saturday @ 7:15

Follow Kate through the underworld (via an emergency C-section), as she meets with long-forgotten ancestors and comes to blows with her recently deceased mother.

Director: Renee Schilling

Dramaturg: Emily Pucell Czarnota

Performers: Laurel Hoffman, Anne McEvoy, Carrie Williams

### Tale of Jiminirising

Jimmie Woody

Thursday @ 7:20 & 8:25,  
Saturday @ 8:15 & 9:20

A theatrical memoir combining poetry, hip hop, and digital storytelling about figuring out how to be a man in the changing landscape of what masculinity means in America.

Director: Sheffia Randall Dooley

Performer: Jimmie Woody

### The Lost Diary

David Hansen & Chennelle Bryant-Harris

Thursday @ 7:50 & 8:55,  
Friday @ 7:45

In the not-too-distant future, white nationalists have declared Holy War, a massive terrorist attack has occurred in D.C., and an injured man must rely on the care of a mysterious woman.

Director: Kelly Elliott

Performers: Bianca McElroy, David Obney

### Wryneck

Lauren Joy Fraley

Friday @ 7:15 & 8:50,  
Saturday @ 7:45 & 8:45

A bird flies across geographical and psychological spaces through Morse code-like patterns, stirring the reality of individual women in separate lives.

Music Co-Creators: Brian Bacon & Lauren Joy Fraley

Performers: Katherine Nash, Hillary Wheelock

## 5 JAMES LEVIN THEATRE

### 4 Veils: An Essay

Lucy Biederman

Friday @ 7:40 & 9:20,  
Saturday @ 7:40 & 8:40

A musical essay/performance exploring veils in a 12 step program, at a minister's pulpit, on President Trump's face, in a Garfield comic strip.

Director: Kat Martin

Performers: Joshua McElroy, Jessica Toltzis

### Bipolar Mixtape

Meredith L. King

Thursday @ 7:15, Friday @ 8:10,  
Saturday @ 9:10

What would 24 hours in the life of a bipolar black woman in a community of neurotypicals look like? *Bipolar Mixtape* invites the audience to step inside a wildly creative bipolar mind.

Director & Original Music Composer:

Meredith L. King

Performers: Tanera Hutz, Courtney D. Love, Shannon Ashley Sharkey, Brenton Sullivan

Musician: Zach Palumbo

### Lie Away Sleeping

Tecia Delores Wilson

Thursday @ 7:55 & 8:55,  
Friday @ 7:10 & 8:50

This is not her first pregnancy, and something feels... off. A mother-to-be battles depression and waves of emotion she has never experienced before.

Creator: Tecia Delores Wilson

Choreographer: Donald Isom

Performers: Kaila Benford, Deja Conner

### Mother Eve's Burden from Black Magic

Darius Stubbs

Thursday @ 8:25 & 9:25,  
Saturday @ 7:10 & 8:10

What is inside the box labeled "Black woman," what does it mean to be eternal mother and sexual fetish, a queen and a slave, and the perpetual sacrifice to the god called "The American Dream?"

Created with & Performed by:

Maya Jones, Terah L'nae McGowan,  
Samantha V. Richards

## 6 GORDON SQUARE THEATRE

### How to End Poverty in 90 Minutes

Michael Rohd, Sojourn Theatre,  
& Collaborators

Thursday @ 7:10, 7:50, 8:30

Sojourn Theatre invites you to be a part of the process as they prepare for their run at CPT (Jan 24-28). As a small test audience, you'll give performers a chance to refine facilitation strategies that exist within the full production.

Presenting Sponsor:

United Way of Greater Cleveland

Performers & Facilitators: Sojourn Theatre Ensemble Artists – Bobby Bermea,\* Jono Eiland, Soneela Nankani,\* Sara Sawicki, Alejandro Tey, Nik Zaleski & Cleveland Artists – Wes Allen, Ananias J. Dixon, Tim Keo, Cathleen O'Malley

\*Actor appears courtesy of Actors' Equity Association, the Union of Professional Actors and Stage Managers in the United States.

# ABOUT NEW PLAY DEVELOPMENT

In just the past 11 years, CPT has produced 97 staged readings and showcases, 107 workshop productions, and 45 full productions of world premieres—in addition to hundreds of community-created plays read, workshopped, and performed through our education and community programs. New Play Development at CPT is at our core.

## PANEL DISCUSSIONS

Saturday afternoon at 2:00pm and 3:30pm  
Panel discussions are free and open to the public.

### Activism and Audience Interaction [2:00]

Moderated by Raymond Bobgan  
[CPT Executive Artistic Director]

#### Panelists

Leila Buck

[Performer & Playwright –  
*American Dreams*]

Michael Rohd

[Sojourn Theatre Artistic Director,  
Conceiver, & Director –  
*How to End Poverty*]

Tamilla Woodard

[Co-Founder, PopUP Theatrics,  
Co-Conceiver & Director –  
*American Dreams*]

### Getting Better as an Artist [3:30]

Moderated by Caitlin Lewins  
[CPT Director of Audience  
Engagement & Media Relations,  
Co-Creator & Performer – *Everything  
is okay (and other helpful lies)*]

#### Panelists

Eric Coble

[Playwright, 16/17 Nord Family  
Foundation Catapult Fellow]

James Ijames

[Playwright,  
InterAct Theatre Company]

Maura Krause

[Artistic Director of Orbiter 3]

cleveland PUBLIC theatre

# ENTRY POINT

2018

A NEW PLAY DEVELOPMENT PROGRAM

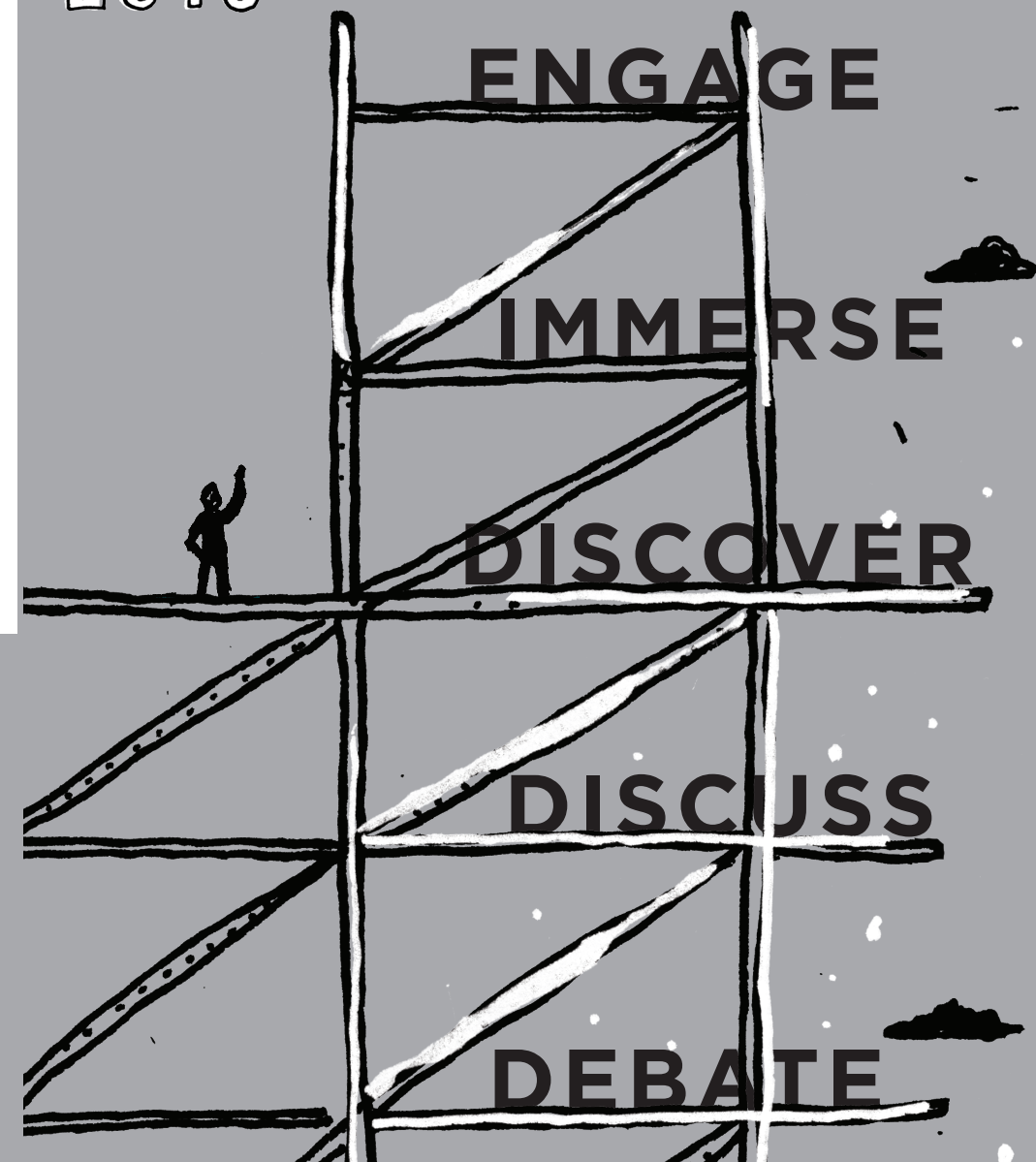

### CLEVELAND PUBLIC THEATRE ENTRY POINT STAFF

Producer: Raymond Bobgan, Executive Artistic Director

Line Producers: Andrew Aaron Valdez, Beth Wood

Production Associate: Kat Martin

Assistant Technical Director: Cayla Destefano

Stage Managers: Tim Collingwood, Merit Glover, Jesse Reagan Hernon,  
Austin Kilpatrick, Yesenia Real-Rivera

SATURDAY, JANUARY 20

THANKS TO OUR  
SPONSORS

THE  
NORD  
Family Foundation

ESTABLISHED 1960  
John P.  
MURPHY  
FOUNDATION

NNPN  
National New Play Network  
Core Member

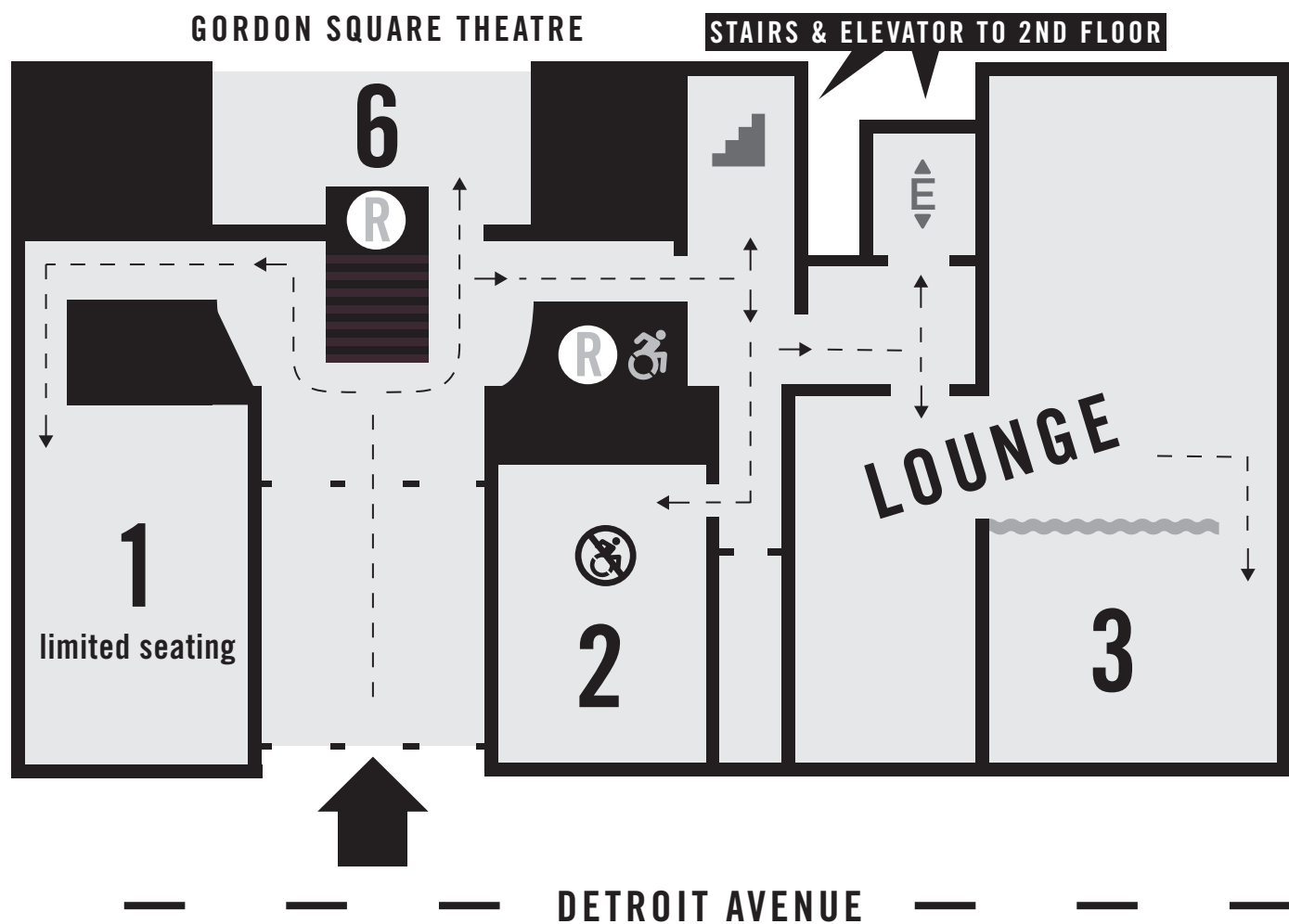

## FIRST FLOOR

### 1. EAST STOREFRONT

*history of walking* by James Ijames  
Friday @ 7:10, Saturday @ 7:10

*The Mint Play* by William James Burke  
Thursday @ 7:10

### 2. FEFU'S KITCHEN

*When the She'll Broke* by Faye Hargate  
Friday @ 7:30-9:00, Saturday @ 7:30-9:00  
Ongoing performance. Come and go at will.

### 3. STOREFRONT STUDIO

*Emergence* by Molly Andrews-Hinders  
Thursday @ 9:10, Friday @ 7:15, Saturday @ 7:15

*Everything is okay (and other helpful lies)*  
by Melissa Crum & Caitlin Lewins  
Thursday @ 7:15, Friday @ 8:00

*The Mint Play* by William James Burke  
Saturday @ 8:00

### 6. GORDON SQUARE THEATRE

*How to End Poverty in 90 Minutes*  
by Michael Rohd, Sojourn Theatre, & Collaborators  
Thursday @ 7:10, 7:50, 8:30

## SECOND FLOOR

### 4. CABARET

*Fingers and Toes* by Renee Schilling  
Thursday @ 9:30, Friday @ 8:20 & 9:20,  
Saturday @ 7:15

*Tale of Jiminirising* by Jimmie Woody  
Thursday @ 7:20 & 8:25, Saturday @ 8:15 & 9:20

*The Lost Diary* by David Hansen & Chennelle  
Bryant-Harris  
Thursday @ 7:50 & 8:55, Friday @ 7:45

*Wryneck* by Lauren Joy Fraley  
Friday @ 7:15 & 8:50, Saturday @ 7:45 & 8:45

### 5. JAMES LEVIN THEATRE

*4 Veils: An Essay* by Lucy Biederman  
Friday @ 7:40 & 9:20, Saturday @ 7:40 & 8:40

*Bipolar Mixtape* by Meredith L. King  
Thursday @ 7:15, Friday @ 8:10, Saturday @ 9:10

*Lie Away Sleeping* by Tecia Delores Wilson  
Thursday @ 7:55 & 8:55, Friday @ 7:10 & 8:50

*Mother Eve's Burden from Black Magic*  
by Darius Stubbs  
Thursday @ 8:25 & 9:25, Saturday @ 7:10 & 8:10

## SATURDAY SCHEDULE

	STAGE 1	STAGE 2	STAGE 3	STAGE 4	STAGE 5
7:00					
7:05					
7:10					MOTHER EVE'S BURDEN... (7:10)
7:15				FINGERS AND TOES (7:15)	
7:20			EMERGENCE (7:15)	TALK BACK	TALK BACK
7:25					
7:30				TALK BACK	
7:35			TALK BACK		
7:40					4 VEILS: AN ESSAY (7:40)
7:45				WRYNECK (7:45)	
7:50	HISTORY OF WALKING (7:10)				TALK BACK
7:55				TALK BACK	
8:00					
8:05		WHEN THE SHE'LL BROKE (7:30)			
8:10					MOTHER EVE'S BURDEN... (8:10)
8:15				TALE OF JIMINIRISING (8:15)	
8:20					TALK BACK
8:25				TALK BACK	
8:30					
8:35					
8:40	TALK BACK		THE MINT PLAY (8:00)		4 VEILS: AN ESSAY (8:40)
8:45				WRYNECK (8:45)	
8:50					TALK BACK
8:55				TALK BACK	
9:00					
9:05					
9:10					BIPOLAR MIXTAPE (9:10)
9:15					
9:20				TALE OF JIMINIRISING (9:20)	
9:25			TALK BACK	TALK BACK	TALK BACK
9:30					
9:35					
9:40	WHEN THE SHE'LL BROKE TALK BACK (9:40)				
9:45					
9:50					
9:55					
10:00					

Join us in the Lounge for mingling and reflection...  
drinks are on us after 9:45!

## HOW TO EXPERIENCE ENTRY POINT

- GRAB A MAP AND PLOT YOUR COURSE**  
It's impossible to see everything in one night!
- THIS IS A LABORATORY**  
Artists are testing out material in the early stages of development.
- ENGAGE WITH THE CREATIVE PROCESS**  
Participate in facilitated feedback after every showing. At the end of the evening, join artists and audience in the Lounge for mingling and reflection.

