

PERFORMANCES

1 EAST STOREFRONT

How Blood Go

Lisa Langford*

Thursday @ 7:35, Saturday @ 7:35
(Full Length)

How Blood Go weaves the present and past together with the story of Quintasia, an African American woman about to embark on a career as a health and fitness expert, and that of her ancestor, Bean, an unwitting participant in a 1930's government experiment on Black men.

Director: Darius J. Stubbs

Dramaturg: Eric Schmiedl

Performers: Ashley Aquilla, Tonya Broach, Kris Ryan Inniss, Sara Katrenich, Sarah Kunchik, CorLesia Smith, Brenton Sullivan, Greg White, Carrie Williams

Breakout Session (or Frogorse)

Nikkole Salter

Friday @ 7:35 (Full Length)

An intimate reading of a play commissioned by CPT with funding from National New Play Network. A corporate training company is vying for the contract for de-escalation and anti-bias training with Cleveland's Police Department. Can a 90-minute training session change people and the world we live in?

Director & Collaborator: Beth Wood

Performers: Nikkole Salter, Beth Wood

2 GORDON SQUARE THEATRE

Excerpts from Fire on the Water

Raymond Bobgan &

India Nicole Burton**

Thursday @ 7:20, Friday @ 7:20,
Saturday @ 7:20 (30 min)

Sections from the larger piece running Feb 14 - Mar 2 at CPT. What happens when we remember the environment is not a lifeless, simplistic phenomenon, but something in which we and our interior selves—our dream selves—connect with?

Performers: Courtney Nicole Auman, Luka Blackhill, Sidney Edwards, Faye Hargate, Brinden Harvey, Shatara Jordan, Michael Levin, Kim Martin, Terah McGowan, Daniel McKinnon, Mary-Francis R. Miller, Zach Palumbo, Adam Seeholzer, Kat Shy, Anastasia Urozhaeva, Hillary Wheelock

Waters (Working Title)

Milta Ortiz & Marc David Pinate

of Borderlands Theater

Thursday @ 8:15, Friday @ 8:15,
Saturday @ 8:15 (30 min)

A collaboration between CPT and Borderlands Theater supported by National New Play Network. A physical theatre reflection on water in our region, created in tandem with a work on water in the desert of Arizona.

Performers: Isaiah Betts, Meiver De la Cruz, Chaunce Hendking, Holly Holsinger

Sorry Doesn't Sweeten Her Tea

Lauren Joy Fraley***

Thursday @ 9:10, Friday @ 9:10
(20 min)

An adaptation of a short story from Helen Oyeyemi's magical realism anthology, *What Is Not Yours Is Not Yours*. Multiple interconnecting worlds jump through time and space.

Performers: Mohammad Gholam Abolfazl, Assad Khaishgi, Akane Little, Brandon X. McSwain

3 CABARET

Living on the Moon

Molly McFadden

Thursday @ 7:15 & 9:25,
Friday @ 7:50 & 9:25
(15 min)

An autobiographical story with music and puppetry examining a woman's relationship with her mother who was diagnosed with Alzheimer's.

Director: Chris Courtenay

Performers: Molly McFadden
with Jim D. Johnston

Bedroom Culture

Hannah Rae Leach

Thursday @ 7:45, Friday @ 8:20,
Saturday @ 8:20 (20 min)

The story of a queer love triangle, *Bedroom Culture* is a theatrical reimagining of the great teen movie, and an exploration of what it means to experience a coming-of-age molded by popular culture and media in 2019.

Director: Arien Hodges

Music: The Prom Queens (Ayana Cheston, Josh Perelman-Hall, Hannah Rae Leach)

Performers: Samantha Cocco, Nicole Coury, Corey East, Alexa Fatheringham, Katherine Nash

Butterfly/Mandela

Cat Kenney

Thursday @ 8:20, Friday @ 8:55,
Saturday @ 7:15 & 9:30
(15 min)

A short play about dimension travel, the Butterfly Effect, and the Mandela Effect. No butterflies or South African Presidents were harmed in the making of this play.

Director: Lynna Metrisin

Performers: Mylin R. Cartwright, Felicit Sanchez

Octet

Twelve Literary Arts

Thursday @ 8:50, Friday @ 7:15,
Saturday @ 7:45 & 8:55
(20 min)

Six poets from Twelve Literary Arts perform a collection of original poetry to spark awareness and call to action.

Performers: Mary Barrett, Kisha Nicole Foster, Raja Belle Freeman, Siaara Freeman, Sage Mack, Damien McClendon

4 JAMES LEVIN THEATRE

Muir and the Bridge (a love story)

Merit Glover

Thursday @ 7:15,
Saturday @ 8:15 & 9:20
(20 min)

Combining magical realism, historical writing about the national park system, and immediate modern day issues, *Muir and the Bridge* explores why we should care if our national parks disappear, and why America protects its land at all.

Director: Jonah Roth

Performers: Emmy Cohen, Doug Kusak, Grace Mitri, Marshare Polk, Hanna Shykind

Tell The Brethren

Tim Collingwood

Thursday @ 7:50 & 8:55,
Friday @ 7:15 & 8:45
(15 min)

A collection of historical and contemporary scenes exploring what it would take to confront sexism in the institutional Catholic church.

Director: Kelly Elliott

Dramaturg: Anne McEvoy

Performers: Adrien Brizzolara, Robert Lucchesi, India Pierre-Ingram, Tammy Shanley

*2018/2019 Nord Family Foundation Playwright Fellow

**2018/2019 National New Play Network Producer in Residence

***2018/2019 Joan Yellen Horvitz Director Fellow

The Tulpa

Tania Benites of Teatro Público
de Cleveland

Thursday @ 8:20 & 9:25,
Friday @ 8:15, Saturday @ 7:15
(15 min)

The Tulpa explores the battle between good and evil within us. Do we control the darkness inside, or let the darkness control us? An excerpt from a longer piece.

Director: Jason Estremera

Performers: Sylka Edmondson, Bianca Flores, Selina Marie Pagan, Beau Reinker, Anthony "TonyFresh" Velez

Standard Starting Pay

Mara Layne & the Gold Men Ensemble

Friday @ 7:45 & 9:15,
Saturday @ 7:45 & 8:50
(15 min)

A devised piece inspired by the life of Emma Goldman, which seeks to challenge economic violence against women and people oppressed by patriarchy in the work place, and explore anarcho-communist solutions through feminine storytelling.

Performers: Dominique Coppella, Mara Layne, Cheryl McConnell



National New Play Network
Core Member

ABOUT NEW PLAY DEVELOPMENT

In just the past 12 years, CPT has produced 118 staged readings and showcases, 114 workshop productions, and 50 full productions of world premieres—in addition to hundreds of community-created plays read, workshopped, and performed through our education and community programs. New Play Development is at our core.

PANEL DISCUSSIONS

Saturday afternoon at 2:00pm and 3:30pm
Panel discussions are free and open to the public.

Who Owns the Story? [2:00pm]

Moderated by Raymond Bobgan
[CPT Executive Artistic Director]

Panelists

Eric Coble

[Playwright, CPT 2016/2017 Nord Family Foundation Playwright Fellow]

Milta Ortiz

[Playwright, Borderlands Theater Associate Artistic Director]

Nikkole Salter

[Playwright]

The Play's Not the Only Thing [3:30pm]

Moderated by Les Hunter
[Playwright, Ohio Representative, Dramatists Guild of America]

Panelists

Amy Mueller

[Playwrights Foundation Artistic Director]

Beth Wood

[CPT Associate Artistic Director & Director of Production]

Saturday's panel discussions are an official Dramatists Guild - Ohio event and will be livestreamed by HowlRound.



cleveland PUBLIC theatre

ENTRY POINT

2019

A NEW PLAY DEVELOPMENT PROGRAM

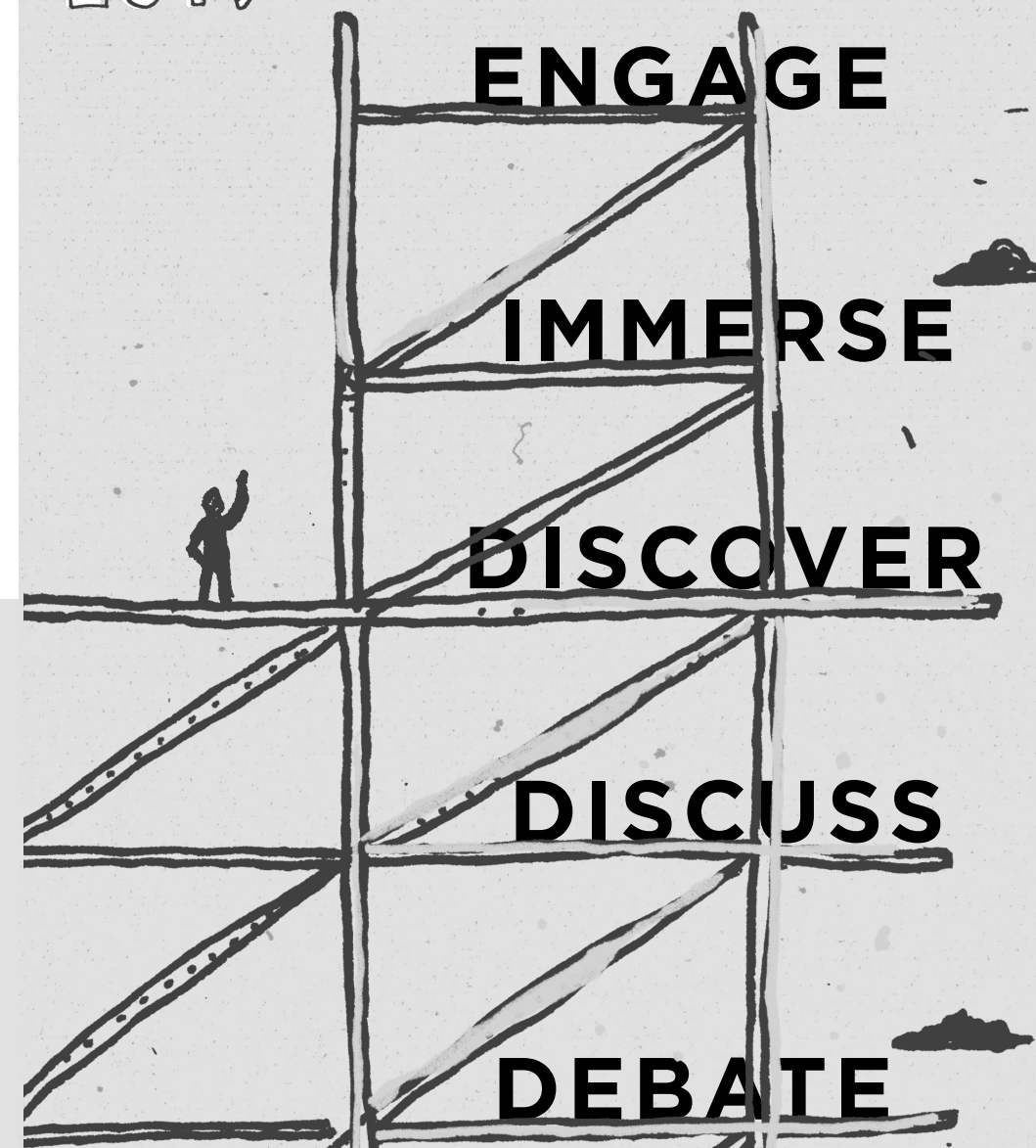

CLEVELAND PUBLIC THEATRE ENTRY POINT STAFF

Producer: Raymond Bobgan, Executive Artistic Director

Line Producer: Molly Andrews-Hinders

Production Associate: Colleen McCaughey

Associate Artistic Director & Director of Production: Beth Wood

Technical Directors: Chris Young, Dan Schumacher

Stage Managers: Maes Lunaria M., Colleen McCaughey,

Yesenia Real, Dezhanay Simmons

SATURDAY, JANUARY 19

THANKS TO OUR
SPONSORS



THE
NORD
Family Foundation



FIRST FLOOR

1. EAST STOREFRONT

How Blood Go by Lisa Langford*
 Thursday @ 7:35, Saturday @ 7:35
Breakout Session (or Frogorse) by Nikkole Salter
 Friday @ 7:35

2. GORDON SQUARE THEATRE

Excerpts from Fire on the Water Co-Directed by Raymond Bobgan & India Nicole Burton**
 Thursday @ 7:20, Friday @ 7:20, Saturday @ 7:20
Waters (Working Title) by Milta Ortiz & Marc David Pinate of Borderlands Theater
 Thursday @ 8:15, Friday @ 8:15, Saturday @ 8:15
Sorry Doesn't Sweeten Her Tea by Lauren Joy Fraley***
 Thursday @ 9:10, Friday @ 9:10

*2018/2019 Nord Family Foundation Playwright Fellow
 **2018/2019 National New Play Network Producer in Residence
 ***2018/2019 Joan Yellen Horvitz Director Fellow

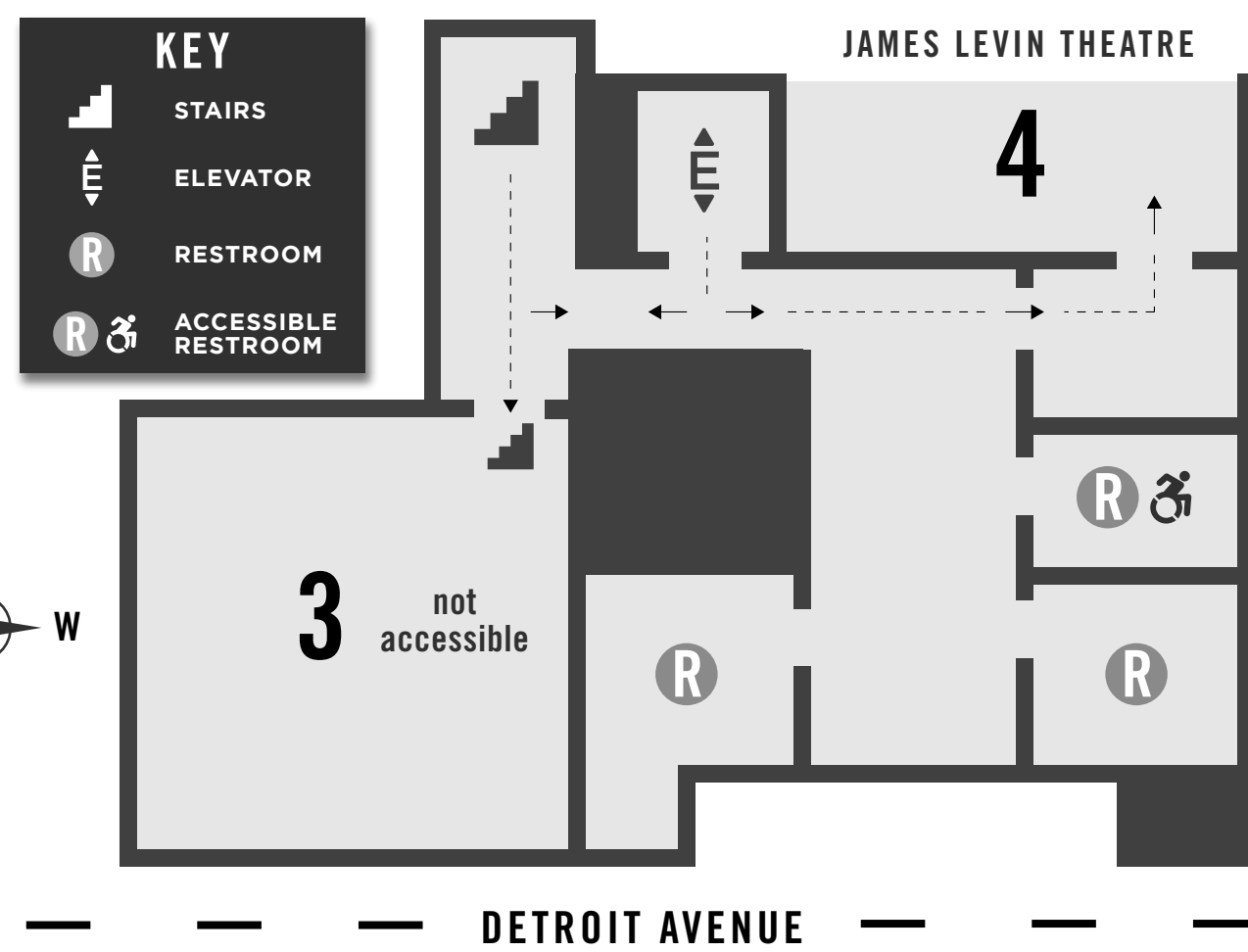

SECOND FLOOR

3. CABARET

Living on the Moon by Molly McFadden
 Thursday @ 7:15 & 9:25, Friday @ 7:50 & 9:25
Bedroom Culture by Hannah Rae Leach
 Thursday @ 7:45, Friday @ 8:20, Saturday @ 8:20
Butterfly/Mandela by Cat Kenney
 Thursday @ 8:20, Friday @ 8:55, Saturday @ 7:15 & 9:30
Octet by Twelve Literary Arts
 Thursday @ 8:50, Friday @ 7:15, Saturday @ 7:45 & 8:55

4. JAMES LEVIN THEATRE

Muir and the Bridge (a love story) by Merit Glover
 Thursday @ 7:15, Saturday @ 8:15 & 9:20
Tell The Brethren by Tim Collingwood
 Thursday @ 7:50 & 8:55, Friday @ 7:15 & 8:45
The Tulpa by Tania Benites of Teatro Público de Cleveland
 Thursday @ 8:20 & 9:25, Friday @ 8:15, Saturday @ 7:15
Standard Starting Pay by Mara Layne & the Gold Men Ensemble
 Friday @ 7:45 & 9:15, Saturday @ 7:45 & 8:50

SATURDAY SCHEDULE

	STAGE 1	STAGE 2	STAGE 3	STAGE 4
7:00				
7:05				
7:10				
7:15			BUTTERFLY/ MANDELA 7:15	THE TULPA 7:15
7:20				
7:25				
7:30		EXCERPTS FROM FIRE ON THE WATER 7:20	TALK BACK	TALK BACK
7:35				
7:40				
7:45				
7:50		TALK BACK	OCTET 7:45	STANDARD STARTING PAY 7:45
7:55				
8:00				
8:05			TALK BACK	TALK BACK
8:10				
8:15				
8:20				MUIR AND THE BRIDGE (A LOVE STORY) 8:15
8:25		WATERS (WORKING TITLE) 8:15	BEDROOM CULTURE 8:20	
8:30	HOW BLOOD GO 7:35			
8:35				TALK BACK
8:40				
8:45		TALK BACK	TALK BACK	
8:50				STANDARD STARTING PAY 8:50
8:55				
9:00			OCTET 8:55	TALK BACK
9:05				
9:10			TALK BACK	
9:15				MUIR AND THE BRIDGE (A LOVE STORY) 9:20
9:20				
9:25				
9:30			BUTTERFLY/ MANDELA 9:30	TALK BACK
9:35				
9:40	TALK BACK			
9:45			TALK BACK	
9:50				

Join us in the Lounge for mingling and reflection... drinks are on us after 9:45!

HOW TO EXPERIENCE ENTRY POINT

- GRAB A MAP AND PLOT YOUR COURSE**
It's impossible to see everything in one night!
- THIS IS A LABORATORY**
Artists are testing out material in the early stages of development.
- ENGAGE WITH THE CREATIVE PROCESS**
Participate in facilitated feedback after every showing. At the end of the evening, join artists and audience in the Lounge for mingling and reflection.